



BCA ARCHITECTS & ENGINEERS

Change Order | Allowance | Pay App Transmittal

BCA Architects & Engineers | 15 Public Square Watertown, New York 13601

PROJECT:	Ogdensburg City School District 2023 Capital Outlay Project 2023-008	DATE SENT:	10/18/2023
		RETURN BY:	10/26/2023
SUBJECT:	CO 1-04 Add'l Subbase	CHANGE ORDER ALLOWANCE PAY APP ID:	01 (GC)-004
TYPE:	Change Order Allowance Pay App	TRANSMITTAL ID:	00254
PURPOSE:	CO/AA For Signature to Owner	VIA:	FedEx/UPS
ACTUAL AMOUNT:	\$18,169.00	ESTIMATED AMOUNT:	\$18,169.00
ACTUAL DAYS:	0	ESTIMATED DAYS:	0

FROM

NAME	COMPANY	EMAIL	PHONE
Linda Rohde	BCA Architects & Engineers	lrohde@thebcgroup.com	(315) 782-8130

TO

NAME	COMPANY	EMAIL	PHONE
Kevin Kendall	Ogdensburg City School District	kkendall@ogdensburgk12.org	(315) 393-0900

REMARKS: Mr. Kendall,

Please review and sign the enclosed document. Retain one (1) copy for your records and return the remaining copies to me. We will forward a copy to SED on the District's behalf.

Change Order No. 1-04 in the amount of \$18,169.00
Contract No. 1 - General Construction
D.C. Building Systems, Inc.

Thank you.

DESCRIPTION OF CONTENTS

QTY	TITLE	NUMBER	DATE	SCALE	SIZE
1	1-04 G701-2017 - Add'l Subbase ContSigned.pdf		10/17/2023		

**Change Order | Allowance |
Pay App Transmittal**

DATE: 10/18/2023
ID: 00254

COPIES:

Rachel Barr

(Ogdensburg City School District)



AIA® Document G701® – 2017

Change Order

PROJECT: <i>(Name and address)</i> 2023 Capital Outlay Project OFA / Golden Dome Ogdensburg City School District 1100 State Street Ogdensburg, NY	CONTRACT INFORMATION: Contract For: No. 1 - General Construction Date: July 3, 2023 SED No. 51-23-00-01-0-007-025	CHANGE ORDER INFORMATION: Change Order Number: 1-04 Date: September 29, 2023 BCA Project No. 2023-008
OWNER: <i>(Name and address)</i> Ogdensburg City School District 1100 State Street Ogdensburg, New York 13669	ARCHITECT: <i>(Name and address)</i> BCA Architects & Engineers 15 Public Square Watertown, New York 13601	CONTRACTOR: <i>(Name and address)</i> D.C. Building Systems, Inc. 1015 Water Street Watertown, New York 13601

THE CONTRACT IS CHANGED AS FOLLOWS:

(Insert a detailed description of the change and, if applicable, attach or reference specific exhibits. Also include agreed upon adjustments attributable to executed Construction Change Directives.)

Add for all labor, material, and equipment to provide additional 876 tons of compacted subbase required to meet grade as a result of varying thicknesses in existing asphalt at Area 3.

The original Contract Sum was	\$ 1,225,000.00
The net change by previously authorized Change Orders	\$ 210,020.00
The Contract Sum prior to this Change Order was	\$ 1,435,020.00
The Contract Sum will be increased by this Change Order in the amount of	\$ 18,169.00
The new Contract Sum including this Change Order will be	\$ 1,453,189.00

The Contract Time will be unchanged by Zero (0) days.
 The new date of Substantial Completion will be

NOTE: This Change Order does not include adjustments to the Contract Sum or Guaranteed Maximum Price, or the Contract Time, that have been authorized by Construction Change Directive until the cost and time have been agreed upon by both the Owner and Contractor, in which case a Change Order is executed to supersede the Construction Change Directive.

NOT VALID UNTIL SIGNED BY THE ARCHITECT, CONTRACTOR AND OWNER.

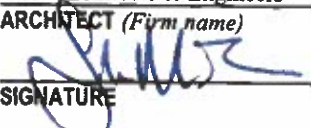
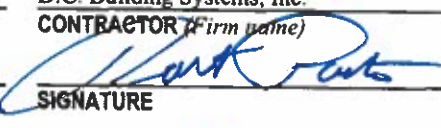
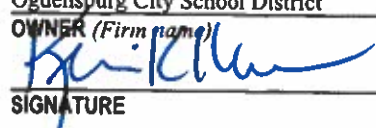
BCA Architects & Engineers ARCHITECT <i>(Firm name)</i>  SIGNATURE Shawn M. Travers, R.A., Principal/Project Architect PRINTED NAME AND TITLE 9/29/23 DATE	D.C. Building Systems, Inc. CONTRACTOR <i>(Firm name)</i>  SIGNATURE Robert Porter President PRINTED NAME AND TITLE 10/11/23 DATE	Ogdensburg City School District OWNER <i>(Firm name)</i>  SIGNATURE Kevin Kendall, Superintendent PRINTED NAME AND TITLE 10/24/23 DATE
---	---	---



DC Building Systems, Inc.
1015 Water Street, Watertown, NY 13601
(315) 785-9884 (315) 785-9767
rporter@dc-buildingsystems.com

8/23/23

Attn: Steve Shockley
BCA Architects & Engineers
15 Public Square.
Watertown, NY 13601

RE: Ogdensburg Schools BC06 Additional Stone

Below please find our proposal to provide additional stone in the area 3 parking lot to meet finish grades. Borings showed existing asphalt thickness to be approximately 3" C8 (4.75"), C9 (3"), C10 (3"), and C11 (2.75) on drawing L100.

Drawing L230 indicated to remove existing paving leaving existing sub-base material. As the borings indicated removing 3" of paving in most locations and the new section was scheduled to be 5" thick we should have had 1-2" of additional stone to reshape the parking lot with. We did not we imported additional stone on 8/1 and 8/2.

Drawing L330 shows contours of the parking lot existing and final to match no way to discern or quantify if additional stone was needed. We did encounter some areas of asphalt adjacent to the outbuildings 8" in thickness that had to be removed. This could account for some of the overage as well as the area in the center we advised on not meeting grades prior to start of demolition work.

Total Additional Stone added 876 Tons.

Total Cost \$15,799

15% OH&P \$2,370

For the sum of: Eighteen Thousand Seven Hundred Sixty-Nine Dollars \$18,169

Sincerely,

Robert Porter

Robert Porter
President

cc. Shawn Travers

Invoice Number: 4347820
 Invoice Date: 08/01/23
 Page: 1
 Terms of Sale: NET 30 DAYS
 Customer Number: 1518864
 Tax Code: NY-NONTA
 Customer Job: 2023 OGDENSBURG CSD CAPIT

INVOICE



Billing on behalf of:

Heidelberg Materials Northeast - NY LLC

D C BUILDING SYSTEMS INC

AUG 7 2023

19085 US RT 11
 WATERTOWN, NY 13601

TO ENSURE PROPER CREDIT, PLEASE INCLUDE
 THE INVOICE NUMBER WITH YOUR PAYMENT
 REMIT TO:

15820 Collection Center Drive
 Chicago, IL 60693-0156

Tax ID: 16-0828484

JOB#223-221				1144144	OGDENSBURG
-------------	--	--	--	---------	------------

Ticket Date	Ticket Number	Truck Type	Ship to Reference	Product Number	Product Description	Quantity	UOM	Unit Price	Amount	Freight	Fuel Surchg/ Other Fee	Extended Price
08/01/23	1510082125	ST		074335	Crusher Run	20.17	Ton	\$18.00	\$363.06		\$0.00	\$363.06
08/01/23	1510082131	ST		074335	Crusher Run	19.74	Ton	\$18.00	\$355.32		\$0.00	\$355.32
08/01/23	1510082134	ST		074335	Crusher Run	19.50	Ton	\$18.00	\$351.00		\$0.00	\$351.00
08/01/23	1510082138	ST		074335	Crusher Run	19.14	Ton	\$18.00	\$344.52		\$0.00	\$344.52
08/01/23	1510082140	ST		074335	Crusher Run	19.87	Ton	\$18.00	\$357.66		\$0.00	\$357.66
08/01/23	1510082146	ST		074335	Crusher Run	19.72	Ton	\$18.00	\$354.96		\$0.00	\$354.96
08/01/23	1510082149	ST		074335	Crusher Run	19.93	Ton	\$18.00	\$358.74		\$0.00	\$358.74
08/01/23	1510082151	ST		074335	Crusher Run	21.22	Ton	\$18.00	\$381.96		\$0.00	\$381.96
08/01/23	1510082152	ST		074335	Crusher Run	19.78	Ton	\$18.00	\$356.04		\$0.00	\$356.04
08/01/23	1510082158	ST		074335	Crusher Run	19.76	Ton	\$18.00	\$355.68		\$0.00	\$355.68
08/01/23	1510082159	ST		074335	Crusher Run	19.66	Ton	\$18.00	\$353.88		\$0.00	\$353.88
08/01/23	1510082161	ST		074335	Crusher Run	19.41	Ton	\$18.00	\$349.38		\$0.00	\$349.38
08/01/23	1510082162	ST		074335	Crusher Run	19.70	Ton	\$18.00	\$354.60		\$0.00	\$354.60
08/01/23	1510082168	ST		074335	Crusher Run	19.89	Ton	\$18.00	\$358.02		\$0.00	\$358.02
08/01/23	1510082169	ST		074335	Crusher Run	20.45	Ton	\$18.00	\$368.10		\$0.00	\$368.10
08/01/23	1510082171	ST		074335	Crusher Run	20.19	Ton	\$18.00	\$363.42		\$0.00	\$363.42
08/01/23	1510082173	ST		074335	Crusher Run	19.82	Ton	\$18.00	\$356.76		\$0.00	\$356.76
08/01/23	1510082176	ST		074335	Crusher Run	19.01	Ton	\$18.00	\$342.18		\$0.00	\$342.18
08/01/23	1510082178	ST		074335	Crusher Run	20.47	Ton	\$18.00	\$368.46		\$0.00	\$368.46
08/01/23	1510082181	ST		074335	Crusher Run	19.38	Ton	\$18.00	\$348.84		\$0.00	\$348.84
08/01/23	1510082183	ST		074335	Crusher Run	19.59	Ton	\$18.00	\$352.62		\$0.00	\$352.62

--PRODUCT SUMMARY--

074335 Crusher Run 416.40
 TOTAL QUANTITY -> 416.40

ENTERED 8/17/23

Subtotal: \$7,495.20

Tax: \$0.00

This invoice is subject to the terms set forth in the Credit Application and/or General Terms and Conditions of Sale, as well as any additional terms and conditions contained in the Quotation or Order Acknowledgement. Any additional or different terms proposed by Buyer are hereby deemed to be a material alteration and are hereby objected to. All items returned are subject to cartage and handling charges. Accounts are due and payable by the above stated terms. Past due accounts are subject to service charges as outlined in the Credit Application and/or General Terms and Conditions of Sale.

Invoice Number: 4348675
 Invoice Date: 08/02/23
 Page: 1
 Terms of Sale: NET 30 DAYS
 Customer Number: 1518864
 Tax Code: NY-NONTA
 Customer Job: 2023 OGDENSBURG CSD CAPIT

INVOICE



Billing on behalf of:

Heidelberg Materials Northeast - NY LLC

D C BUILDING SYSTEMS INC

19085 US RT 11
 WATERTOWN, NY 13601

TO ENSURE PROPER CREDIT, PLEASE INCLUDE
 THE INVOICE NUMBER WITH YOUR PAYMENT
 REMIT TO:

15620 Collection Center Drive
 Chicago, IL 60693-0156

Tax ID: 16-0928494

JOB#223-221				1144144	OGDENSBURG
-------------	--	--	--	---------	------------

Ticket Date	Ticket Number	Truck Type	Ship to Reference	Product Number	Product Description	Quantity	UOM	Unit Price	Amount	Freight	Fuel Surchg/ Other Fee	Extended Price
08/02/23	1510082222	ST		074332	Fine Crusher Run	22.02	Ton	\$18.75	\$412.88		\$0.00	\$412.88
08/02/23	1510082201	ST		074335	Crusher Run	22.33	Ton	\$18.00	\$401.94		\$0.00	\$401.94
08/02/23	1510082202	ST		074335	Crusher Run	22.33	Ton	\$18.00	\$401.94		\$0.00	\$401.94
08/02/23	1510082206	ST		074335	Crusher Run	23.43	Ton	\$18.00	\$421.74		\$0.00	\$421.74
08/02/23	1510082209	ST		074335	Crusher Run	21.90	Ton	\$18.00	\$394.20		\$0.00	\$394.20
08/02/23	1510082214	ST		074335	Crusher Run	21.52	Ton	\$18.00	\$387.36		\$0.00	\$387.36
08/02/23	1510082218	ST		074335	Crusher Run	21.71	Ton	\$18.00	\$390.78		\$0.00	\$390.78
08/02/23	1510082225	ST		074335	Crusher Run	21.79	Ton	\$18.00	\$392.22		\$0.00	\$392.22
08/02/23	1510082231	ST		074335	Crusher Run	22.04	Ton	\$18.00	\$396.72		\$0.00	\$396.72
08/02/23	1510082234	ST		074335	Crusher Run	21.71	Ton	\$18.00	\$390.78		\$0.00	\$390.78
08/02/23	1510082237	ST		074335	Crusher Run	21.83	Ton	\$18.00	\$394.74		\$0.00	\$394.74
08/02/23	1510082238	ST		074335	Crusher Run	21.80	Ton	\$18.00	\$394.20		\$0.00	\$394.20
08/02/23	1510082243	ST		074335	Crusher Run	22.01	Ton	\$18.00	\$396.18		\$0.00	\$396.18
08/02/23	1510082244	ST		074335	Crusher Run	21.14	Ton	\$18.00	\$380.52		\$0.00	\$380.52
08/02/23	1510082245	ST		074335	Crusher Run	20.66	Ton	\$18.00	\$371.88		\$0.00	\$371.88
08/02/23	1510082247	ST		074335	Crusher Run	21.84	Ton	\$18.00	\$392.52		\$0.00	\$392.52
08/02/23	1510082251	ST		074335	Crusher Run	21.70	Ton	\$18.00	\$390.60		\$0.00	\$390.60
08/02/23	1510082254	ST		074335	Crusher Run	21.15	Ton	\$18.00	\$380.70		\$0.00	\$380.70
08/02/23	1510082259	ST		074335	Crusher Run	22.47	Ton	\$18.00	\$404.46		\$0.00	\$404.46
08/02/23	1510082265	ST		074335	Crusher Run	22.68	Ton	\$18.00	\$407.88		\$0.00	\$407.88
08/02/23	1510082267	ST		074335	Crusher Run	22.37	Ton	\$18.00	\$402.66		\$0.00	\$402.66

--PRODUCT SUMMARY--

074332 Fine Crusher Run 22.02
 074335 Crusher Run 438.39
 TOTAL QUANTITY --> 460.41

Subtotal: \$8,303.90

Tax: \$0.00

PAID
 8/8/23
 DPD

This invoice is subject to the terms set forth in the Credit Application and/or General Terms and Conditions of Sale, as well as any additional terms and conditions contained in the Quotation or Order Acknowledgement. Any additional or different terms proposed by Buyer are hereby deemed to be a material alteration and are hereby objected to. All items returned are subject to cartage and handling charges. Accounts are due and payable by the above stated terms. Past due accounts are subject to service charges as outlined in the Credit Application and/or General Terms and Conditions of Sale.

Barret laid out the grades on the existing asphalt area that is low based upon the new grading plan. Below circled in red is a rough sketch of the area in question. Area is roughly 18,000sf at an average of 3" low. Varies from 1-6". We will import additional stone required to meet the new finish grades unless you want to regrade the area. I will have Cliff provide Zach copies of tickets to tally what is added in.

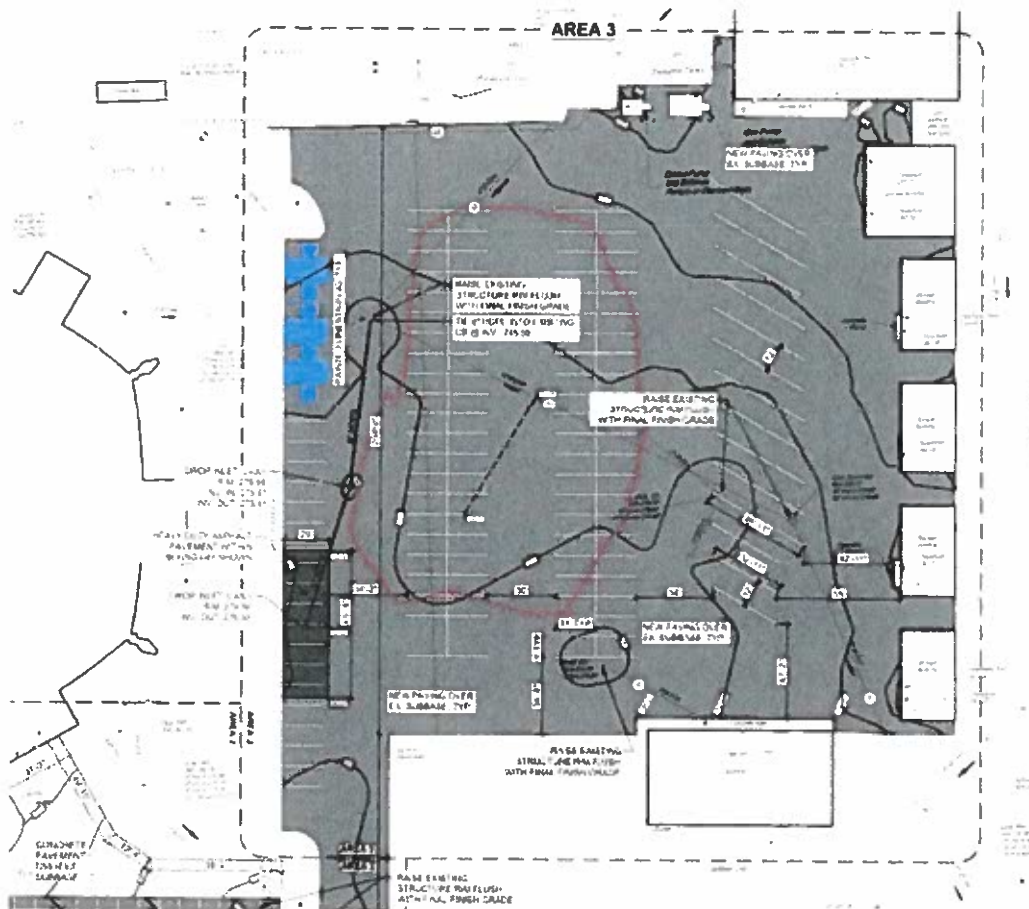

DC BUILDING SYSTEMS INC.
 10000 16th Avenue, Suite 100, Richmond, BC V6V 2G9
 TEL: (604) 273-1111 FAX: (604) 273-1112

From: Bob Porter

Sent: Friday, July 28, 2023 2:20 PM

To: Steve Shockley <sshockley@thebcgroup.com>

Cc: Shawn Travers <stravers@TheBCGroup.com>; Zachary Smith <zsmith@thebcgroup.com>; Pat DEWEY <pdewey@barrettpaving.com>; Cliff Loomis <cliff@dc-buildingsystems.com>; 'HARRIMAN, Ricki (BIC New York North)' <rharriman@barrettpaving.com>

Subject: RE: Grades

Barret was back onsite this afternoon working verifying the grading. The issue appears to be isolated to a portion of area 3 (where we are starting Monday milling.

I have also attached several pictures from Area 3. Appears to be very little stone under the blacktop on top of a sandy material possibly item 4. Should look at this Monday.

Robert Porter

President

DC Building Systems Inc.

1015 Water Street

Watertown, NY 13601

Phone (315) 785-9884

Cell (315) 778-1226



From: Bob Porter

Sent: Friday, July 28, 2023 10:06 AM

To: Steve Shockley <sshockley@thebcgroup.com>

Cc: Shawn Travers <stravers@TheBCGroup.com>; Zachary Smith <zsmith@thebcgroup.com>; Pat DEWEY <pdewey@barrettpaving.com>

Subject: Grades

finish grades for the parking lots. the intent was to match existing grading can you please confirm that?

Based upon the machine grades in the cad file provided, we would have to leave the existing blacktop and add about an inch of stone and then pave on that raising the grades on the entire site 4 to 6 inches I don't believe that's the correct intention.

With a Mill already on site to begin Monday, our thought is to take some shots of the existing blacktop and match back to that I can provide the file from Aubertine. They developed from your cad file separately if desired.

Robert Porter

President

DC Building Systems Inc.

Mobile (315) 778-1226

DATE	1	L100	REVIEW
------	---	------	--------

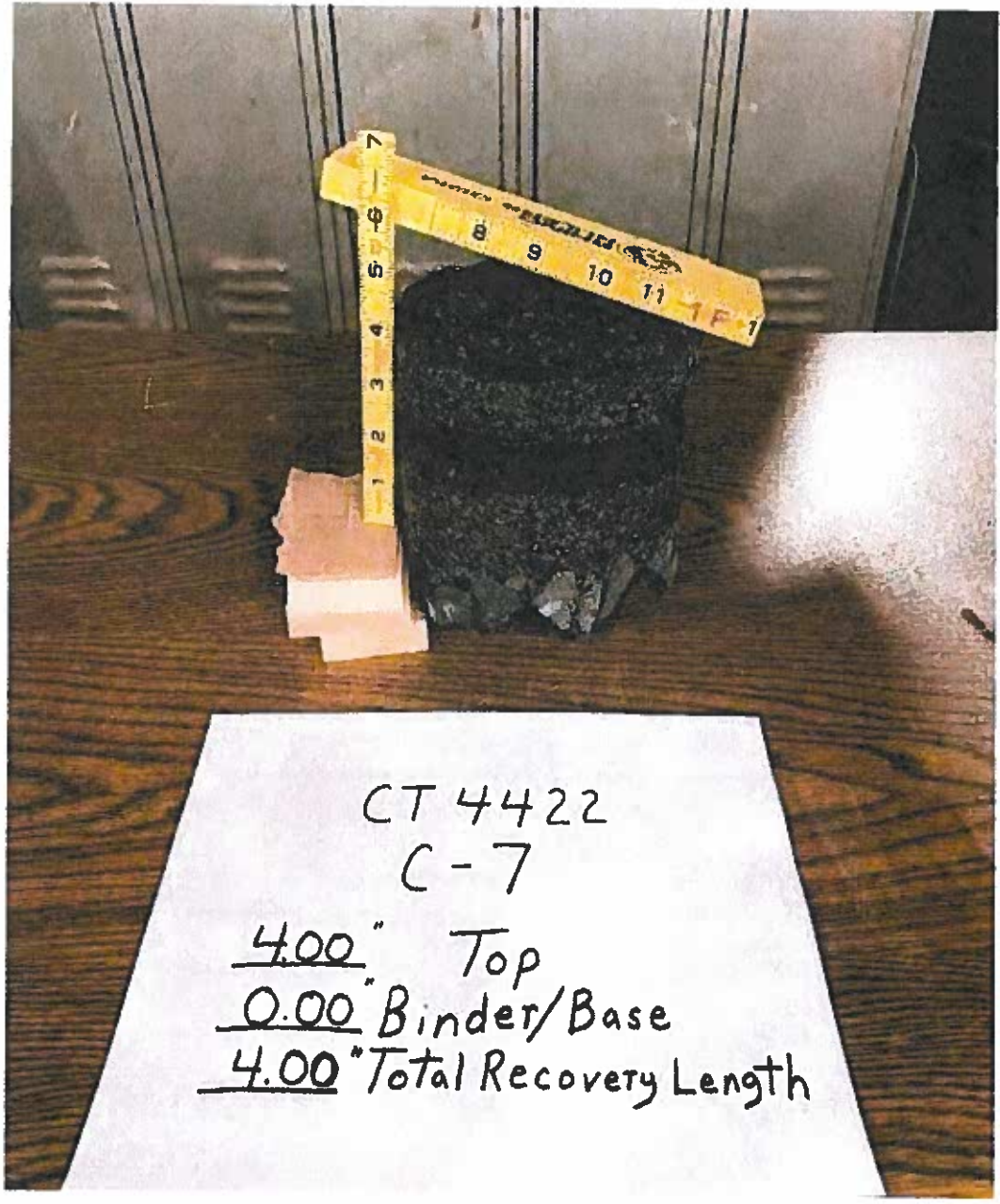

ATLANTIC TESTING LABORATORIES, LIMITED
Ogdensburg Free Academy Parking Lots Project
Ogdensburg, St. Lawrence County, New York
ATL Report No. CT4422D-01-03-23
Ogdensburg City School District c/o BCA Architects & Engineers
PAVEMENT CORE PHOTOGRAPHIC LOG

Core No.	Photograph
C-7	 <p>The photograph shows a dark, cylindrical pavement core sample resting on a wooden surface. A yellow measuring tape is positioned vertically next to the core, with the top of the core aligned with the 4-inch mark. A small, light-colored rectangular object is placed at the base of the core. In the foreground, a white piece of paper contains handwritten text: "CT 4422", "C-7", "<u>4.00</u>\" Top", "<u>0.00</u>\" Binder/Base", and "<u>4.00</u>\" Total Recovery Length".</p>

ATLANTIC TESTING LABORATORIES, LIMITED
Ogdensburg Free Academy Parking Lots Project
Ogdensburg, St. Lawrence County, New York
ATL Report No. CT4422D-01-03-23
Ogdensburg City School District c/o BCA Architects & Engineers
PAVEMENT CORE PHOTOGRAPHIC LOG

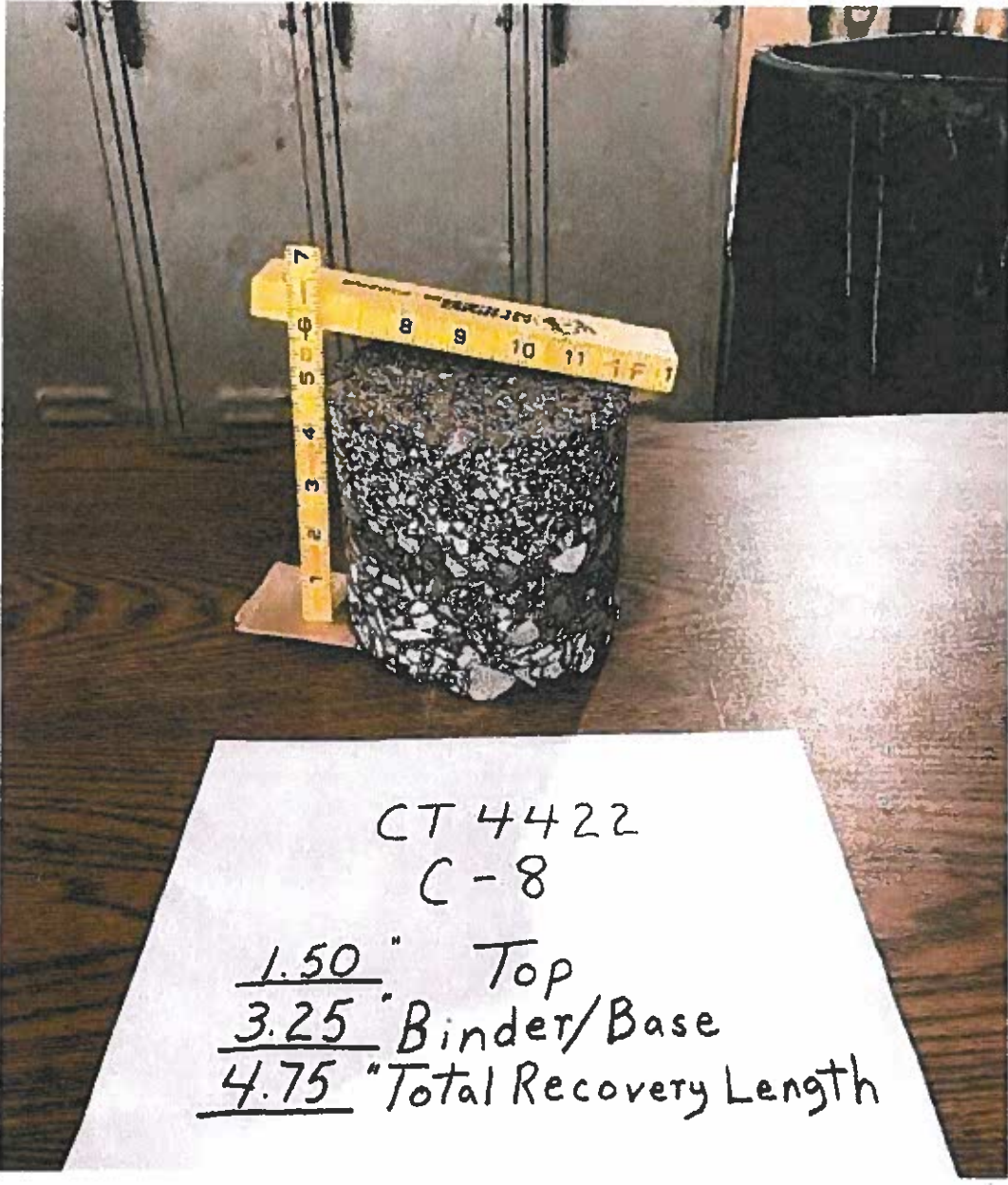
Core No.	Photograph
C-8	 <p>The photograph shows a cylindrical pavement core sample labeled C-8. A yellow measuring tape is placed vertically next to the core, showing a height of approximately 4.75 inches. The core is composed of three distinct layers: a top layer of dark, fine-grained material, a middle layer of lighter-colored binder/base material, and a bottom layer of coarse aggregate. A handwritten label on a white piece of paper in the foreground provides the following information:</p> <p>CT 4422 C-8 <u>1.50"</u> Top <u>3.25"</u> Binder/Base <u>4.75"</u> Total Recovery Length</p>

ATLANTIC TESTING LABORATORIES, LIMITED
Ogdensburg Free Academy Parking Lots Project
Ogdensburg, St. Lawrence County, New York
ATL Report No. CT4422D-01-03-23
Ogdensburg City School District c/o BCA Architects & Engineers
PAVEMENT CORE PHOTOGRAPHIC LOG

Core No.	Photograph
C-9	

ATLANTIC TESTING LABORATORIES, LIMITED
Ogdensburg Free Academy Parking Lots Project
Ogdensburg, St. Lawrence County, New York
ATL Report No. CT4422D-01-03-23
Ogdensburg City School District c/o BCA Architects & Engineers
PAVEMENT CORE PHOTOGRAPHIC LOG

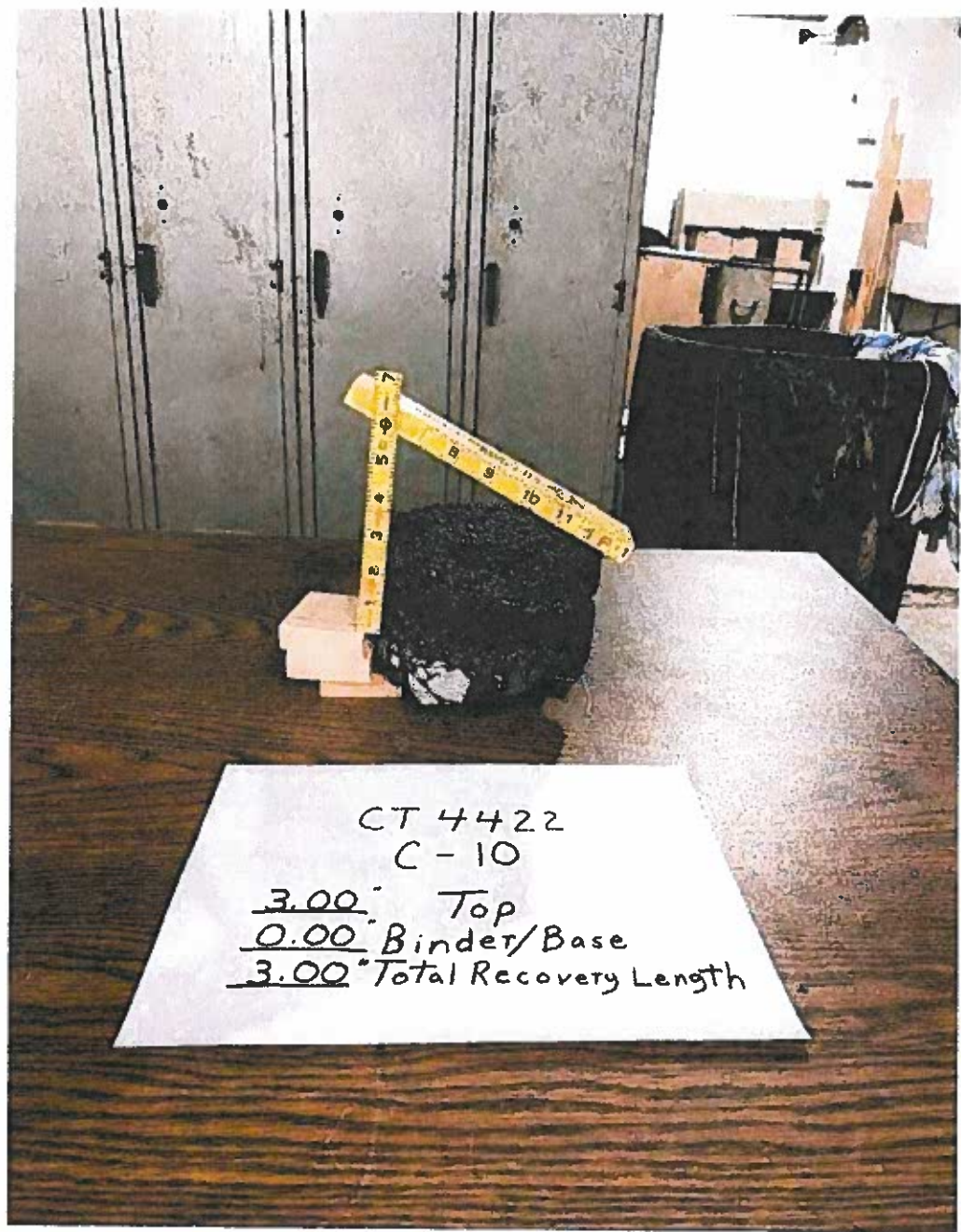
Core No.	Photograph
C-10	

ATLANTIC TESTING LABORATORIES, LIMITED
Ogdensburg Free Academy Parking Lots Project
Ogdensburg, St. Lawrence County, New York
ATL Report No. CT4422D-01-03-23
Ogdensburg City School District c/o BCA Architects & Engineers
PAVEMENT CORE PHOTOGRAPHIC LOG

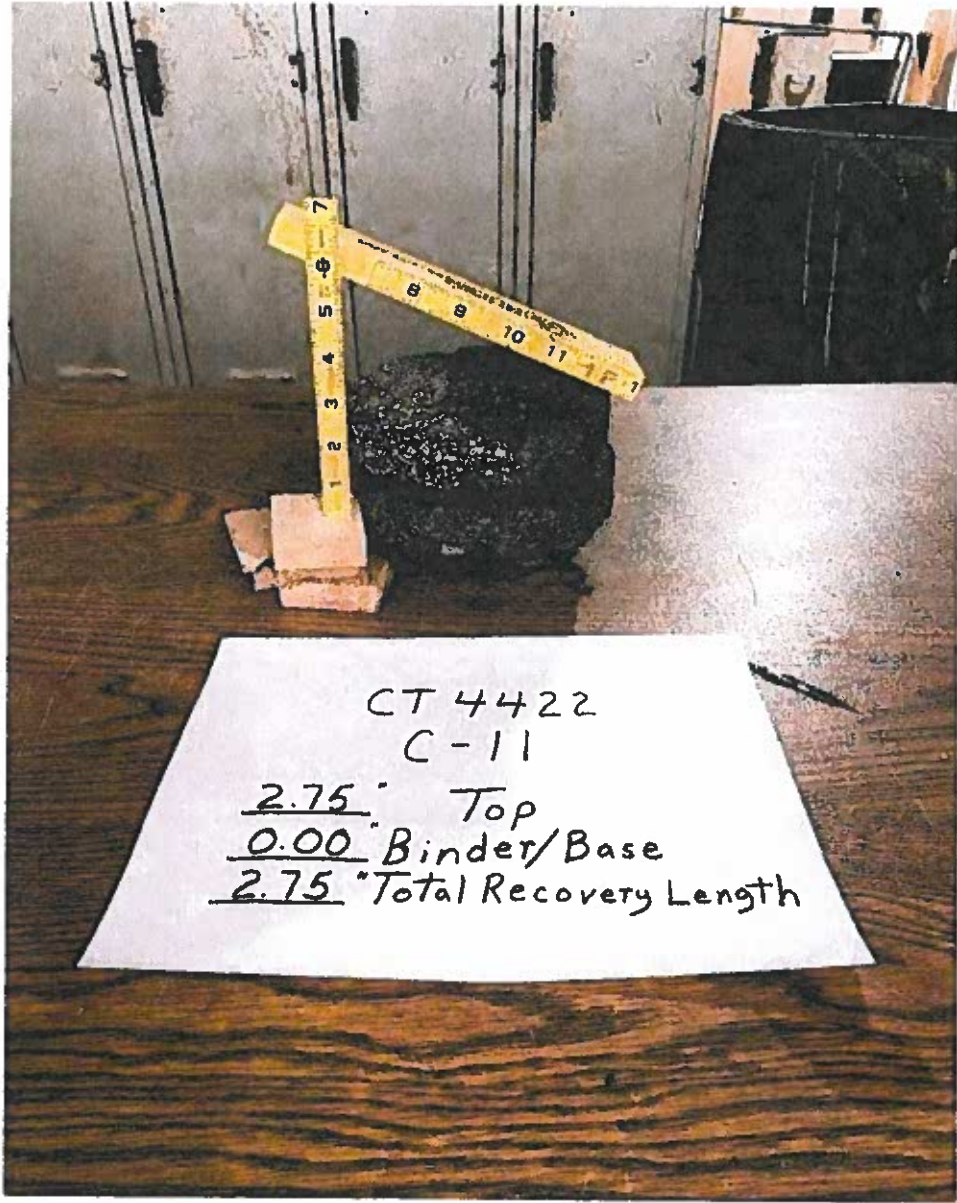
Core No.	Photograph
C-11	 <p>The photograph shows a dark, irregularly shaped pavement core sample resting on a wooden surface. A yellow L-shaped ruler is placed against the sample for scale. In the foreground, a white piece of paper contains handwritten text: "CT 4422", "C-11", "<u>2.75</u>\" Top", "<u>0.00</u>\" Binder/Base", and "<u>2.75</u>\" Total Recovery Length".</p>

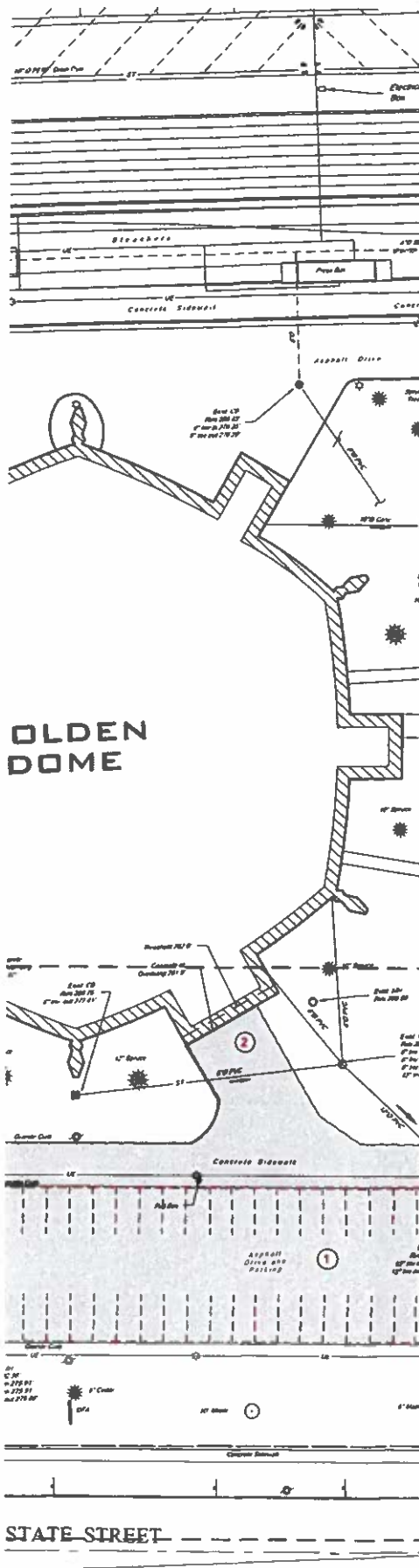

DRAWING NOTES: 1. SEE SHEET L100 FOR GENERAL NOTES

DEMOLITION NOTES

1. MILL AND REMOVE ASPHALT PAVEMENT PARKING LOTS & DRIVES TO LIMITS SHOWN
2. SAWCUT & REMOVE CONCRETE PAVEMENT TO BOUNDARY SHOWN
3. SAWCUT & REMOVE CONCRETE PAVEMENT & SUBBASE MATERIALS TO BOUNDARY SHOWN
4. REMOVE ADA PARKING SIGN(S) AS NECESSARY TO MATCH PROPOSED PARKING STRIPING. SEE L320 AND L400
5. SAWCUT, MILL AND REMOVE TOP COURSE ASPHALT PAVEMENT IN NYS DOT RIGHT-OF-WAY TO LIMITS SHOWN. BINDER COURSE AND SUBBASE TO REMAIN

KEY PLAN

RED CONTROL NO. 51-23-00-01-0 007-025

THIS SHEET INCORPORATES COLOR GRAPHICS WHICH INDICATE IMPORTANT INFORMATION AND SHALL BE PRINTED IN COLOR IF REPRODUCED BY A CONTRACTOR.

BCA Architects & Engineers
Ithaca | Saratoga Springs | Watertown

WWW.THEBCAGROUP.COM

COPYRIGHT © 2023 BCA ARCHITECTS & ENGINEERS. WARNING: IT IS A VIOLATION OF THE NEW YORK STATE EDUCATION LAW FOR ANY UNAUTHORIZED ALTERATIONS TO THIS DOCUMENT AFTER ARTICLE 341 AND 342

BCA
ARCHITECTS
ENGINEERS



OGDENSBURG CITY SCHOOL DISTRICT
2023 CAPITAL OUTLAY PROJECT
OFA / GOLDEN DOME

OGDENSBURG - NY LAWRENCE - NEW YORK

REV	DATE	DESCRIPTION
1		
2		
3		
4		
5		
6		
7		
8		
9		
10		

DRAWN BY JTM	PROJECT NUMBER 2023-008
CHECKED BY JTM	DATE 06/02/2023

SITE DEMOLITION PLAN - AREA

BUILDING	SHEET NUMBER
1	L230

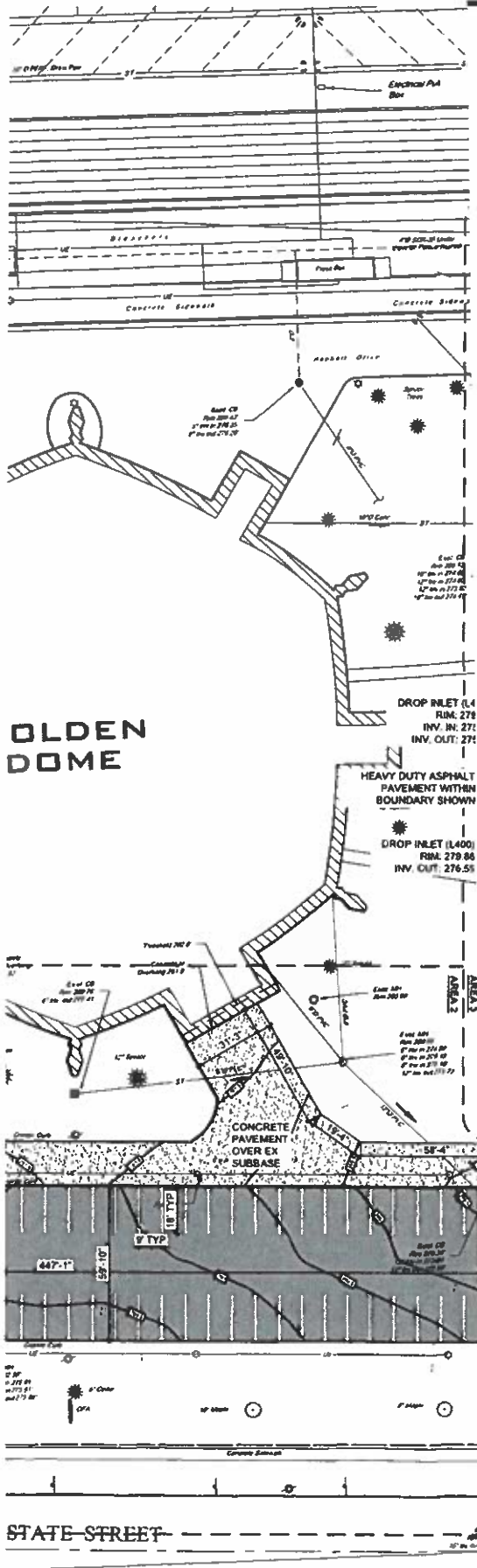

SITE LEGEND

- HEAVY DUTY ASPHALT PAVEMENT
- ASPHALT PAVING OVER EXG SUBBASE
- ASPHALT PAVING IN NYSDOT R.O.W.
- CONCRETE PAVEMENT
- HEATED CONCRETE SLAB
- PARKING STRIPING



KEY PLAN

SED CONTROL NO. 51-23-00-01-0-007-025

THIS SHEET INCORPORATES COLOR GRAPHICS WHICH INDICATE IMPORTANT INFORMATION AND SHALL BE PRINTED IN COLOR IF REPRODUCED BY A CONTRACTOR.

BCA Architects & Engineers
Ithaca | Saratoga Springs | Watertown

WWW.THEBCAGROUP.COM
COPYRIGHT © 2023 BCA ARCHITECTS & ENGINEERS. WARNING: IT IS A VIOLATION OF THE NEW YORK STATE ENGINEERING LAW FOR ANY UNAUTHORIZED ALTERATIONS TO THIS DOCUMENT AS PER ARTICLE 143 AND 147.

BCA
ARCHITECTS
ENGINEERS



OGDENSBURG CITY SCHOOL DISTRICT
2023 CAPITAL OUTLAY PROJECT
OFA / GOLDEN DOME
OGDENSBURG - ST LAWRENCE - NEW YORK

REV	DATE	DESCRIPTION

DRAWN BY	PROJECT NUMBER
CHECKED BY	DATE
	06/02/2023

**SITE LAYOUT & GRADING
PLAN - AREA 3**

BUILDING	SHEET NUMBER
1	L330

THE STATE EDUCATION DEPARTMENT / THE UNIVERSITY OF THE STATE OF NEW YORK

Office of Facilities Planning, 89 Washington Avenue, Room 1060 Education Building Annex, Albany, NY 12234

Tel. (518) 474-3906

Tel. (518) 474-3906

www.p12.nysed.gov/facplan/

CHANGE ORDER CERTIFICATION

Must be attached to back of Change Order

Instructions: This CERTIFICATION is required for all change orders submitted to SED

Fill out all three parts completely.

Change Order Number:

1-04

Part One - General Information
Provide separate Change Orders for each Project Number

SED Project Number

5	1	2	3	0	0	0	1	0	0	0	7	0	2	5
---	---	---	---	---	---	---	---	---	---	---	---	---	---	---

District BEDS Code

Building Identification Number

Project number

District & Building Name

Ogdensburg City School District, Ogdensburg Free Academy / Golden Dome

Type of Project

☒ Reconstruction /Alteration
 ☐ Addition & Alteration
 ☐ New Building
 ☐ Other

Project Description

2023 Capital Outlay Project

Architect / Engineer firm

BCA Architects & Engineers 15 Public Square; Watertown, New York 13601

name

address

Contact Person

Shawn M. Travers, R.A. Principal/Architect

(315) 782-8130 Ext. 235 / stravers@thebcgroup.com

name & title

phone number & e-mail

Construction Manager firm

BCA Architects & Engineers 15 Public Square; Watertown, New York 13601

name

address

Contact Person

Stephen Shockley Project Administrator

(315) 782-8130 Ext. 290 / sshockley@thebcgroup.com

name & title

phone number & e-mail

District Contact Person

Kevin Kendall, Superintendent of Schools

(315) 393-0900

kkendall@ogdensburgK12.org

name & title

phone number & e-mail

Part Two

Provide the following information for each individual item in the change order:

(Number each item if there is more than one and provide additional sheets as necessary.)

- A. Requested By (Who initiated the change request)
- B. Relationship to Project Scope (How is this change related to the original project scope)
- C. Basis of Need (Describe why the change is needed)
- D. Description of Work (Provide a detailed description of the work or services provided in the change order. Provide text, a drawing or both as necessary to demonstrate code compliance and the individual cost of each item.)

A	General Contractor
B	Under the Capital Outlay Project, the existing parking lot noted in Area 3 was scheduled for reconstruction as per Contract Drawings L230 and L330.
C	During removals, the General Contractor discovered that the thickness of existing asphalt varied greatly throughout Area 3. Pre-construction borings indicated an existing asphalt depth of 3-inches; while demolition revealed an asphalt section as much as 8-inches. As such, additional subbase material was provided to make up the difference with the new 5-inch pavement section.
D	Add to provide all labor, materials, and equipment for additional 876 tons of compacted subbase required to meet grade as a result of varying thickness in existing asphalt at Area 3.

CHANGE ORDER CERTIFICATION

Part Three

1

Change order requirements:

- ✓ The scope of the change order must relate to the project scope previously approved.
- ✓ Dollar amounts applied from allowances toward costs associated with the changes must be provided.
- ✓ If the cost of this change order is not within the approved amount as currently established on the SA-4, please provide a Form FP-FI, Request for Revision of Financial Information, with documentation showing the additional authorization of funds.
- ✓ Each change order shall be signed by the president of the board of education, the architect/engineer, and the contractor.

2

Certification of the Superintendent of Schools (District Superintendent if a BOCES project)

The following statements are true and correct to the best of my knowledge and belief:

- The revised total cost is within the authorized appropriation for this project.
- Where any work of this change order requires a type or kind of work that is not included in the original contract documents, the school district's attorney has been contacted to assure conformance with the Opinion of the State Comptroller No. 60-505.

10/24/23

Date



Kevin Kendall, Superintendent of Schools

3

Certification of the Architect or Engineer

The following statements are true and correct to the best of my knowledge and belief:

- Work required by this change order is in accordance with applicable sections of the approved contract documents.
- Any plan, sketch, or attachment referenced in this change order is included herein.
- Work required by this change order is in accordance with applicable provisions of the NYS Uniform Fire Prevention and Building Code, State Education Department's building standards, and NYS Department of Labor's Code Rule 56.
- Work required by this change order was designed by an architect or engineer who is currently licensed by the State of New York.
- Work required by this change order that involves asbestos-containing building material (ACBM) was designed by an architect or engineer who is currently licensed by the State of New York and who is appropriately certified as an asbestos designer by the NYS Department of Labor at the time he/she designed the asbestos-related project.

9/29/23

Date

BCA Architects & Engineers

Architectural / Engineering Firm Name

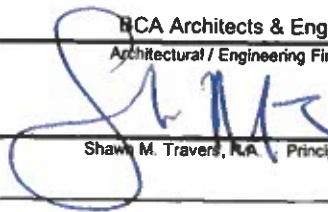

Shawn M. Travers, R.A., Principal/Architect