



CCO #SC01-001

C&S Companies
 499 Col Eileen Collins Blvd.
 Syracuse, New York 13212
 Phone: (315) 455-2000

Project: AS7.001.001 - Ogdensburg CSD CIP Phase 1
 1100 State Street
 Ogdensburg, New York 13669

**Change Order Authorization #SC01-001:
 CE #040 - Transportation Entrance Gate Changes**

CONTRACT COMPANY:	Day Automation (Victor) 7931 Rae Blvd. Victor, New York 14564	CONTRACT FOR:	Contract No. SC-01:Sound & Security
DATE CREATED:	4/30/2026	CHANGE REASON:	Client Request
REFERENCE:	SED Control No. 51-23-00-01-5-022-001	TOTAL AMOUNT:	\$41,578.36

ATTACHMENTS:
[2-AD3/C-601: STANDARD SITE DETAILS Rev.3.pdf](#) [_JC1-06: UTILITY PLAN Rev.3.pdf](#) [_2-C-100: SITE PLAN Rev.2.pdf](#) [_2-EL100: ELECTRICAL SITE PLAN Rev.1.pdf](#)

CHANGE ORDER LINE ITEMS:

At the District's request, enhanced communication and security capabilities are being added at the entrance gate to the new Transportation Facility, per attached JC-14 drawings.	\$41,578.36
---	-------------

The Original Contract Sum	\$ 229,961.46
Net change by previously authorized Change Orders	\$ 0.00
The contract sum will be changed by this Change Order in the amount of	\$ 41,578.36
The Revised Contract Value including this Change will be	\$ 271,539.82
The contract time will be changed by this Change Order by 0 days	

Ogdensburg City School District
 1100 State Street
 Ogdensburg, New York 13669

BCA Architects & Engineers
 15 Public Square
 Watertown, New York 13601

 SIGNATURE DATE

 SIGNATURE DATE

C&S Companies
 499 Col Eileen Collins Blvd.
 Syracuse New York 13212

Day Automation (Victor)
 7931 Rae Blvd.
 Victor New York 14564

 05/07/2026

 SIGNATURE DATE

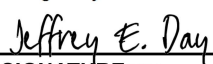
Signed by:
 5/06/2026

 SIGNATURE DATE

- LEGEND**
- Square Catch Basin
 - Flow Direction
 - Manhole
 - Utility Pole
 - Guy Anchor
 - ▲ Single Post Sign
 - ▲ Double Post Sign
 - ▲ Highway Monument
 - Centerline
 - Property Line

- NOTES**
1. Underground utilities shown are from field location if possible. Others are shown from available record data, their exact location may be different from that as shown and others may exist. As always it is the contractor's responsibility to notify Dig Safely - New York at (800) 962-7962 prior to any excavation.
 2. The site survey was performed November 2022.
 3. The horizontal datum for this survey is based on NYS East Zone NAD83(2011) (North American Datum 1983/2011).
 4. The Vertical Datum for this survey is based on the North American Vertical Datum of 1988 (NAVD88).

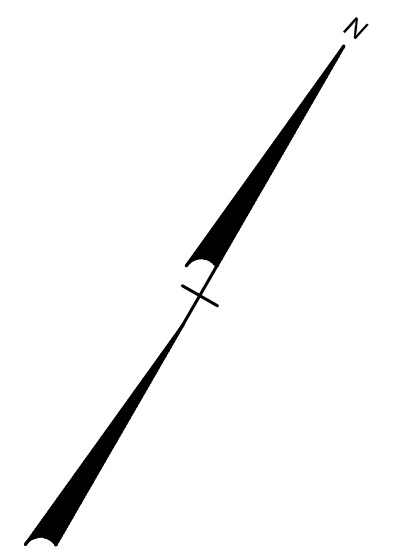
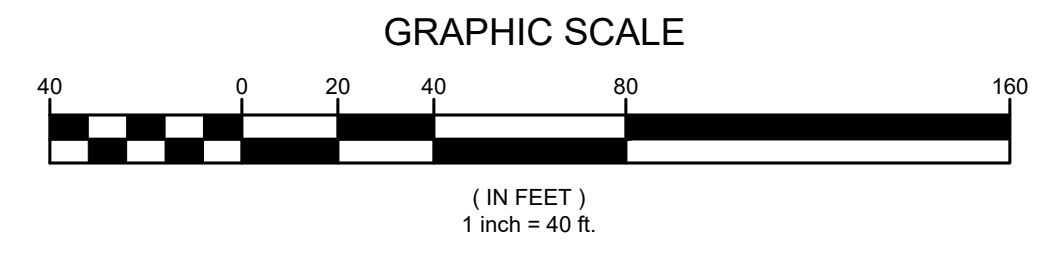

59.32-1-3.211 Tax Parcel Number

- Coniferous Tree
- Deciduous Tree
- Shrub
- Stump
- Proposed Fence
- Proposed Pond

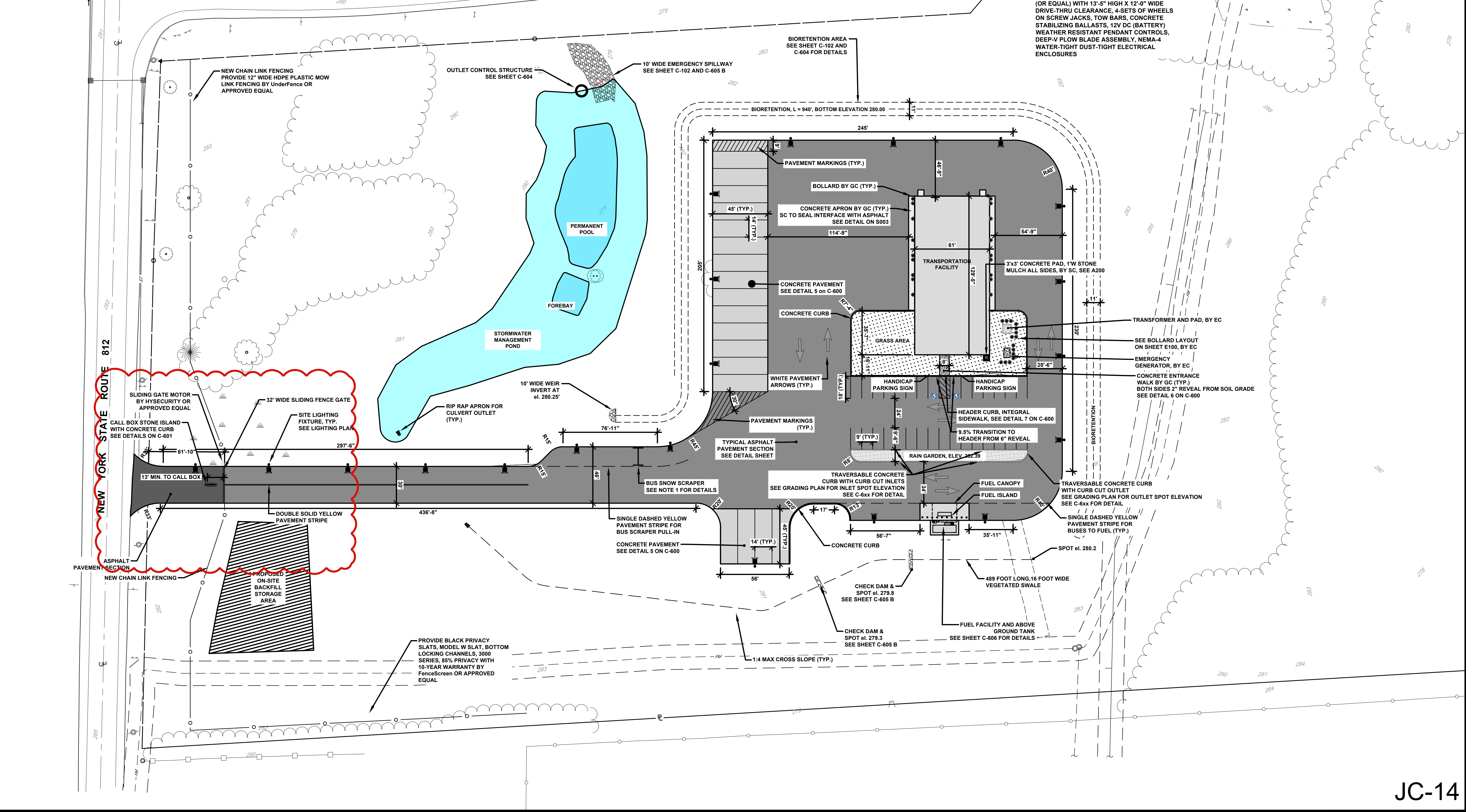

- NOTES:**
1. INCLUDE THE FOLLOWING: 11'-2" LONG X 16'-4" WIDE X 17'-9" HIGH MEDIUM DUTY MD-12B PORTABLE FLEETFLOW BY SCRAPER SYSTEMS (OR EQUAL) WITH 13'-5" HIGH X 12'-0" WIDE DRIVE-THRU CLEARANCE, 4-SETS OF WHEELS ON SCREW JACKS, TOW BARS, CONCRETE STABILIZING BALLASTS, 12V DC (BATTERY) WEATHER RESISTANT PENDANT CONTROLS, DEEP-V PLOW BLADE ASSEMBLY, NEMA-4 WATER-TIGHT DUST-TIGHT ELECTRICAL ENCLOSURES

KEY PLAN:

SED CONTROL NO. 51-23-00-01-5-022-001
 THIS SHEET INCORPORATES COLOR GRAPHICS WHICH INDICATE IMPORTANT INFORMATION AND SHALL BE PRINTED IN COLOR IF REPRODUCED BY A CONTRACTOR.

BCA Architects & Engineers
 Ithaca | Saratoga Springs | Watertown
 WWW.THEBCGROUP.COM
 COPYRIGHT © 2023 BCA ARCHITECTS & ENGINEERS. WARNING - IT IS A VIOLATION OF THE NEW YORK STATE EDUCATION LAW FOR ANY UNAUTHORIZED ALTERATIONS TO THIS DOCUMENT AS PER ARTICLE 16 AND 17.



OGDENBURG CITY SCHOOL DISTRICT
 CAPITAL IMPROVEMENTS PROJECT - PHASE 1
 NEW TRANSPORTATION FACILITY
 OGDENBURG- ST. LAWRENCE - NEW YORK

REV	DATE	DESCRIPTION
1	01/03/2025	SED ADD. NO. 1
2	12/18/2025	JC-14 ENTRANCE REVISIONS

DRAWN BY AFF	PROJECT NUMBER 2022-014A
CHECKED BY MDA	DATE 02/28/2025

SITE PLAN	
BUILDING	SHEET NUMBER
JC-14	2
	C-100

- LEGEND**
- Square Catch Basin
 - Flow Direction
 - Manhole
 - Utility Pole
 - Guy Anchor
 - Single Post Sign
 - Double Post Sign
 - ▲ Highway Monument
 - Centerline
 - Property Line
 - 59.32-1-3.211 Tax Parcel Number
 - ☀ Coniferous Tree
 - Deciduous Tree
 - Shrub
 - Stump
 - Proposed Fence
 - Proposed Pond

- NOTES**
1. Underground utilities shown are from field location if possible. Others are shown from available record data, their exact location may be different from that as shown and others may exist. As always it is the contractor's responsibility to notify Dig Safely - New York at (800) 962-7962 prior to any excavation.
 2. The site survey was performed November 2022.
 3. The horizontal datum for this survey is based on NYS East Zone NAD83(2011) (North American Datum 1983/2011).
 4. The vertical datum for this survey is based on the North American Vertical Datum of 1988 (NAVD88).

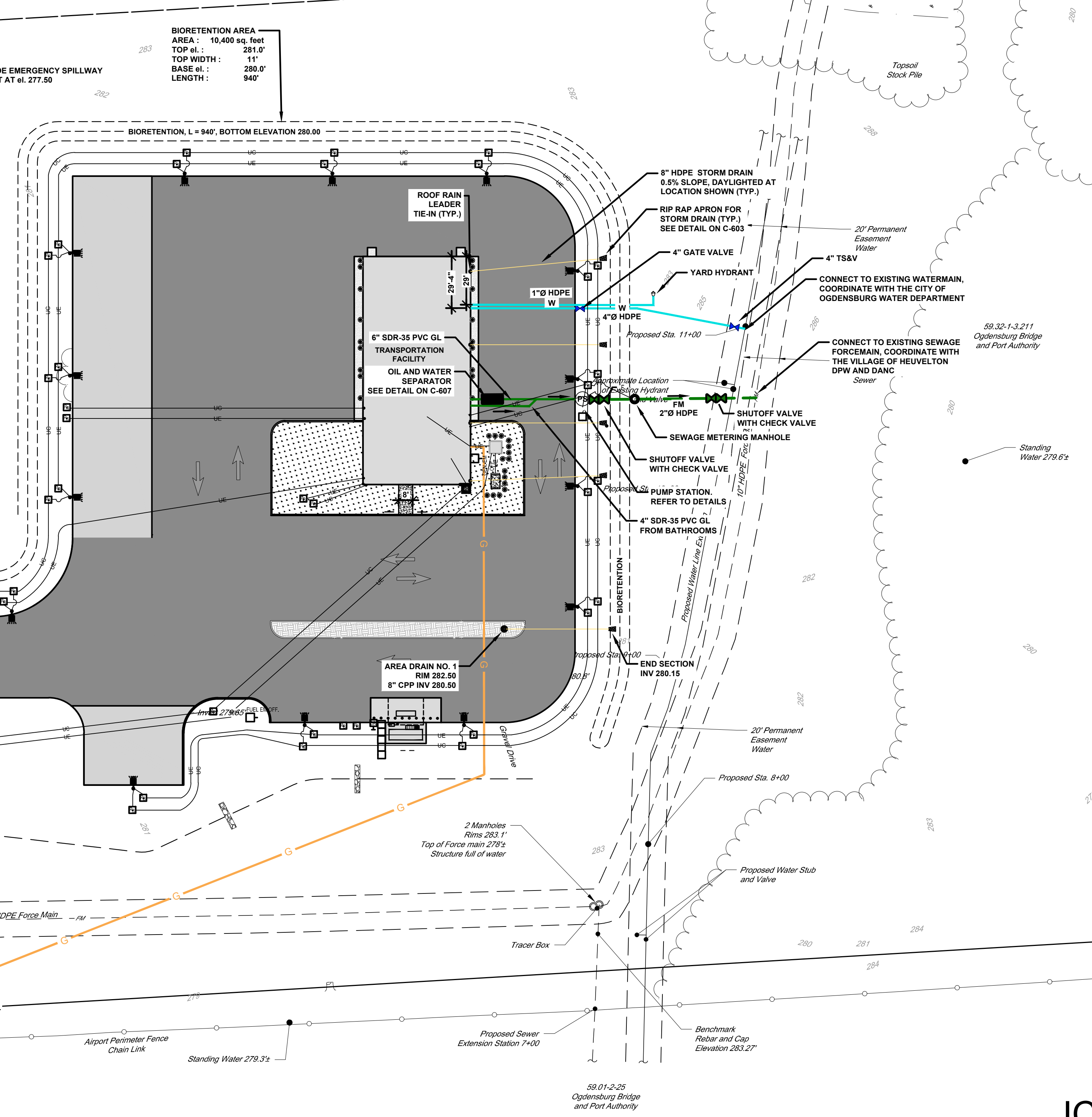
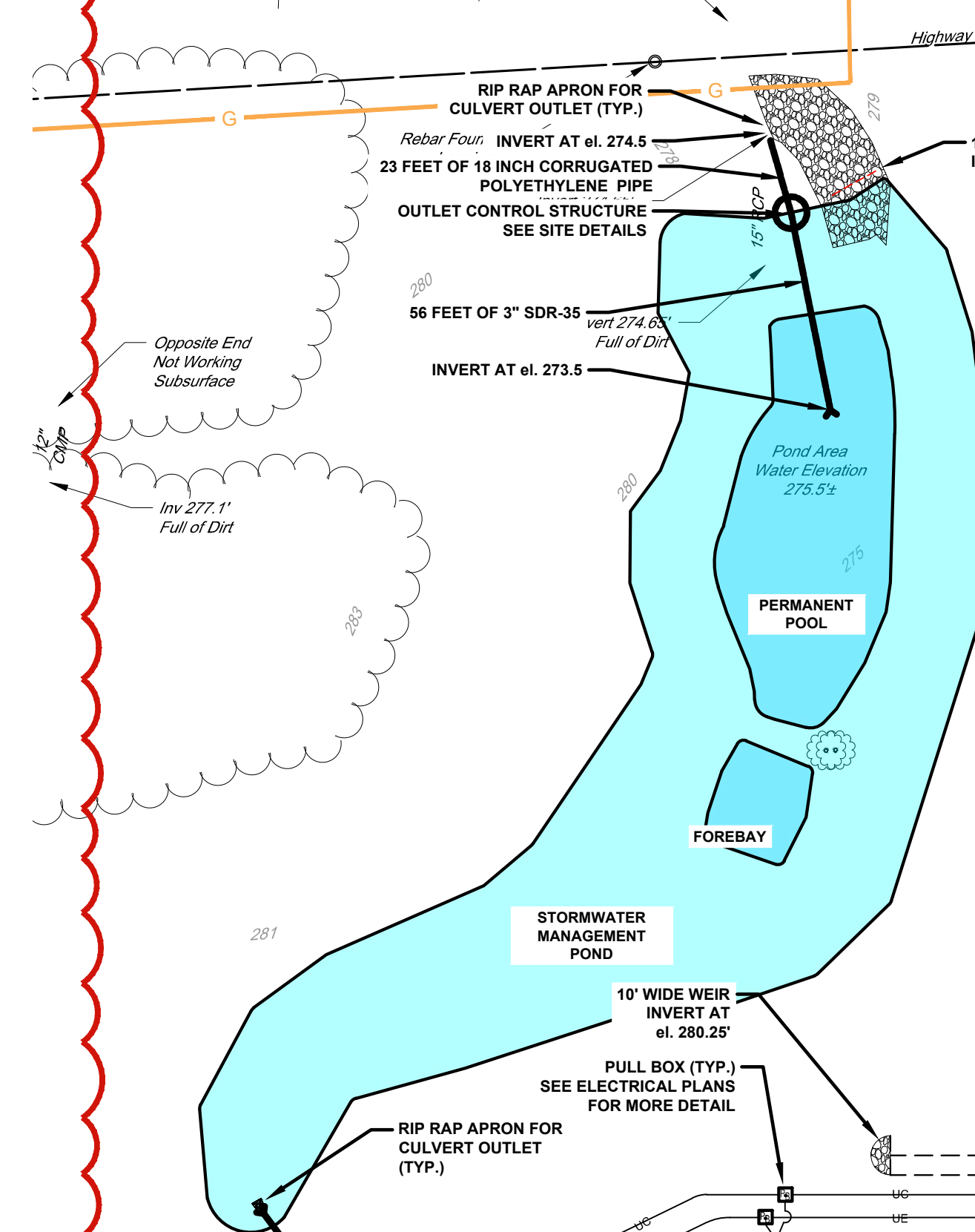
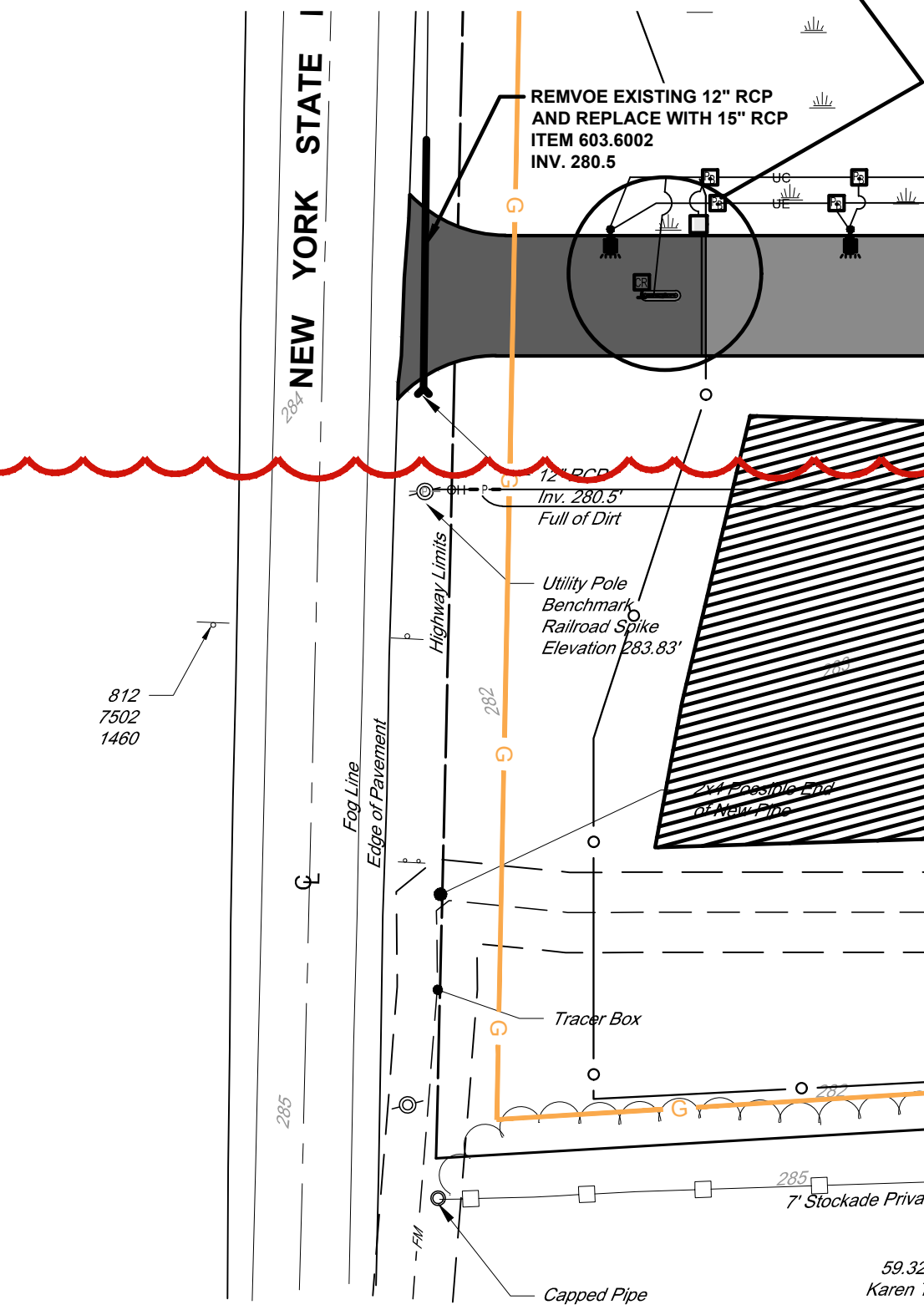
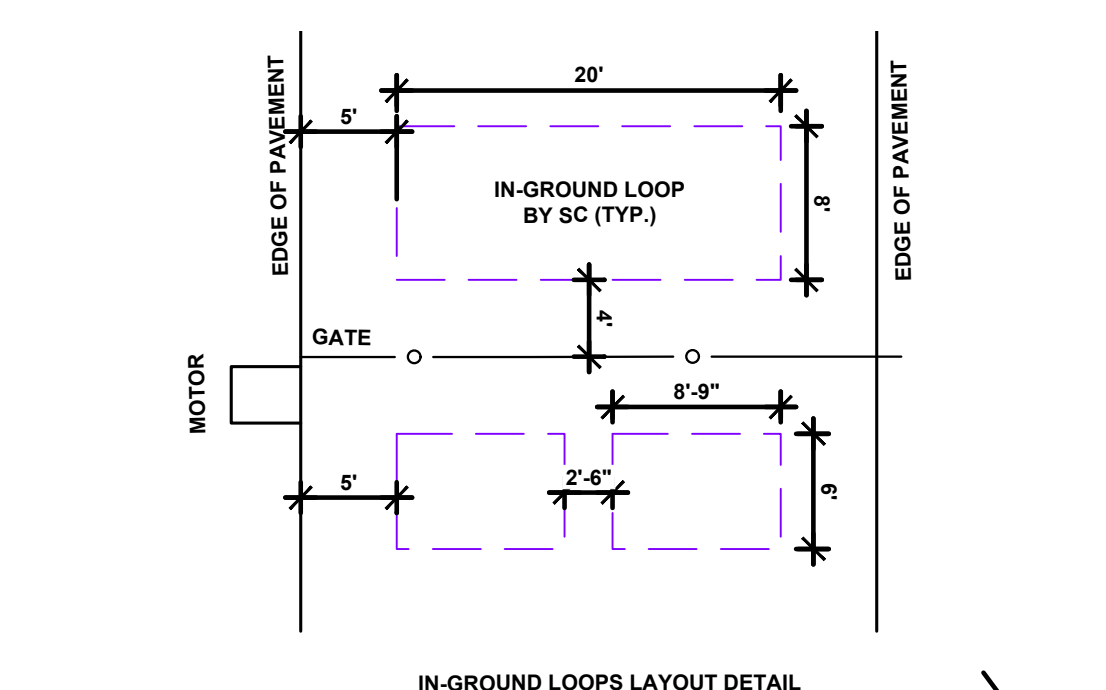
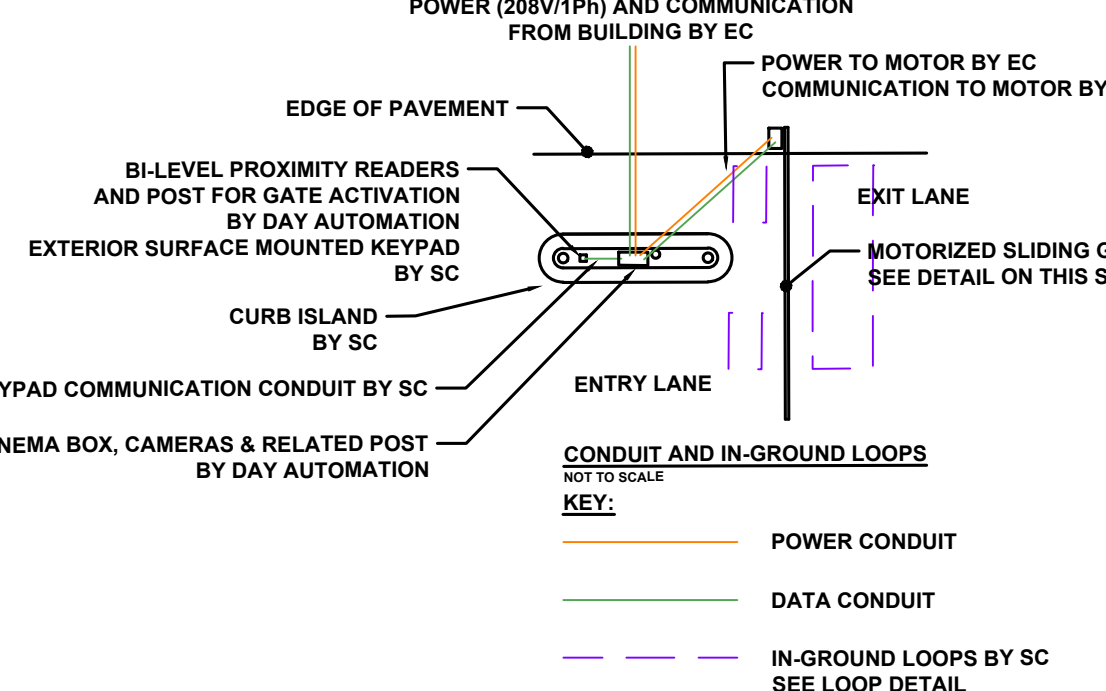
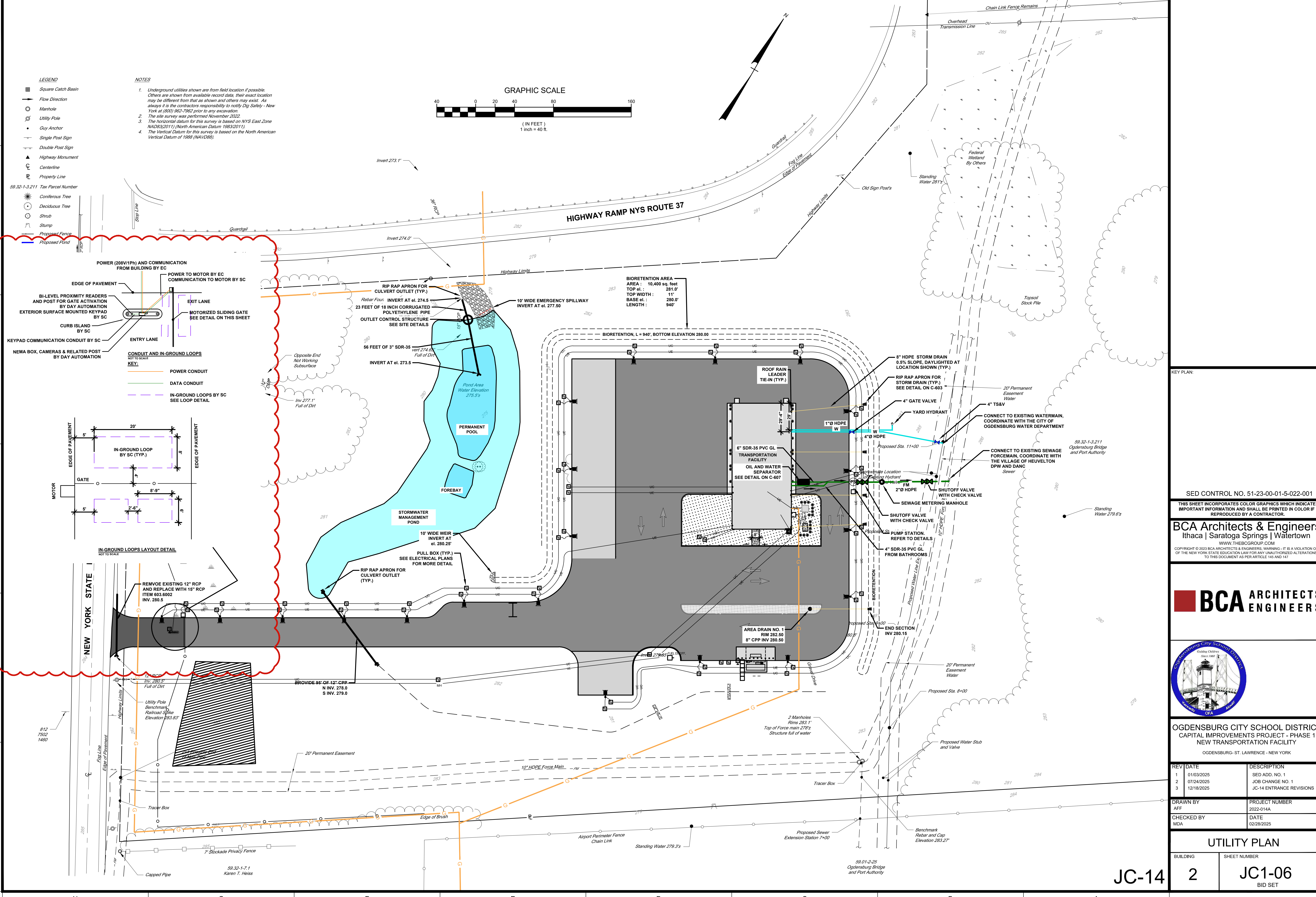
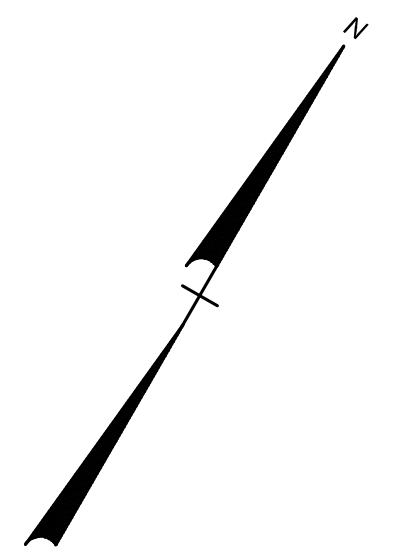
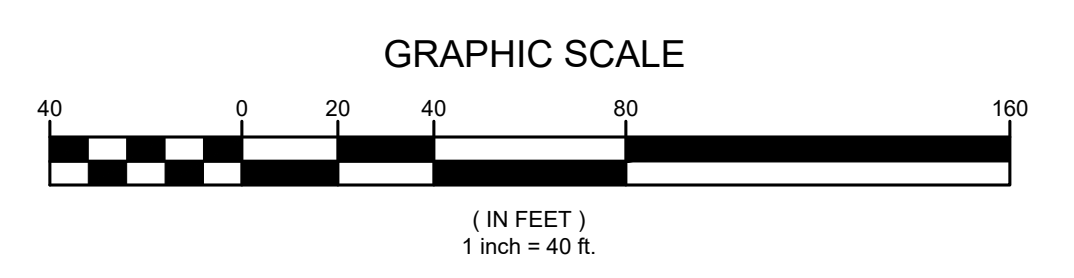

KEY PLAN:

SED CONTROL NO. 51-23-00-01-5-022-001

THIS SHEET INCORPORATES COLOR GRAPHICS WHICH INDICATE IMPORTANT INFORMATION AND SHALL BE PRINTED IN COLOR IF REPRODUCED BY A CONTRACTOR.

BCA Architects & Engineers
Ithaca | Saratoga Springs | Watertown

WWW.THEBCGROUP.COM

COPYRIGHT © 2023 BCA ARCHITECTS & ENGINEERS, WARNING - IT IS A VIOLATION OF THE NEW YORK STATE EDUCATION LAW FOR ANY UNAUTHORIZED ALTERATIONS TO THIS DOCUMENT AS PER ARTICLE 16 AND 17

BCA ARCHITECTS ENGINEERS

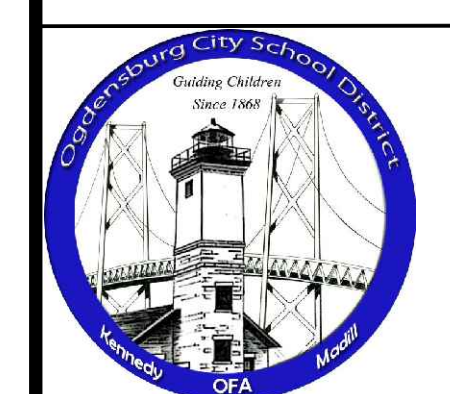

OGDENSBURG CITY SCHOOL DISTRICT
CAPITAL IMPROVEMENTS PROJECT - PHASE 1
NEW TRANSPORTATION FACILITY
OGDENSBURG - ST. LAWRENCE - NEW YORK

REV	DATE	DESCRIPTION
1	01/03/2025	SED ADD. NO. 1
2	07/24/2025	JOB CHANGE NO. 1
3	12/18/2025	JC-14 ENTRANCE REVISIONS

DRAWN BY AFF	PROJECT NUMBER 2022-014A
CHECKED BY MDA	DATE 02/28/2025

UTILITY PLAN	
BUILDING	SHEET NUMBER
JC-14	2
JC1-06	BID SET

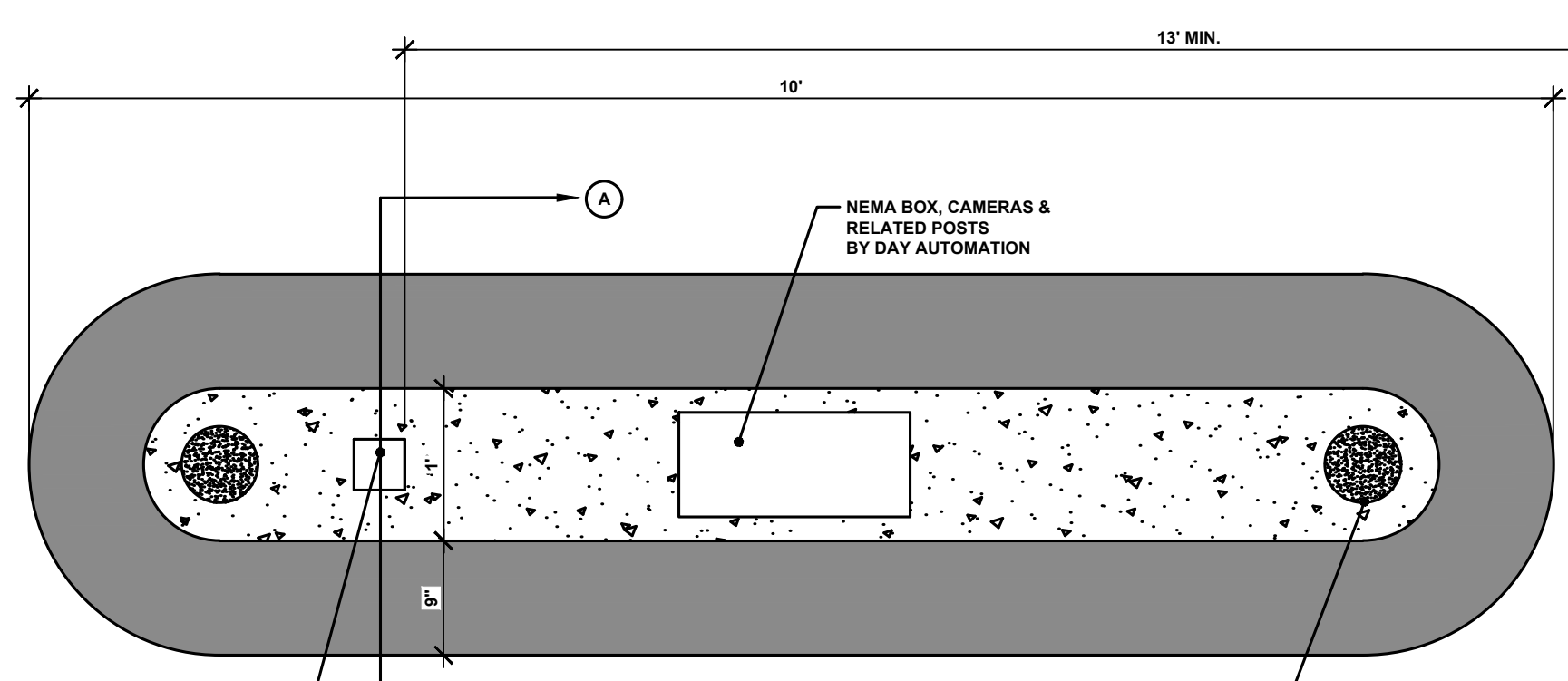

TOP VIEW

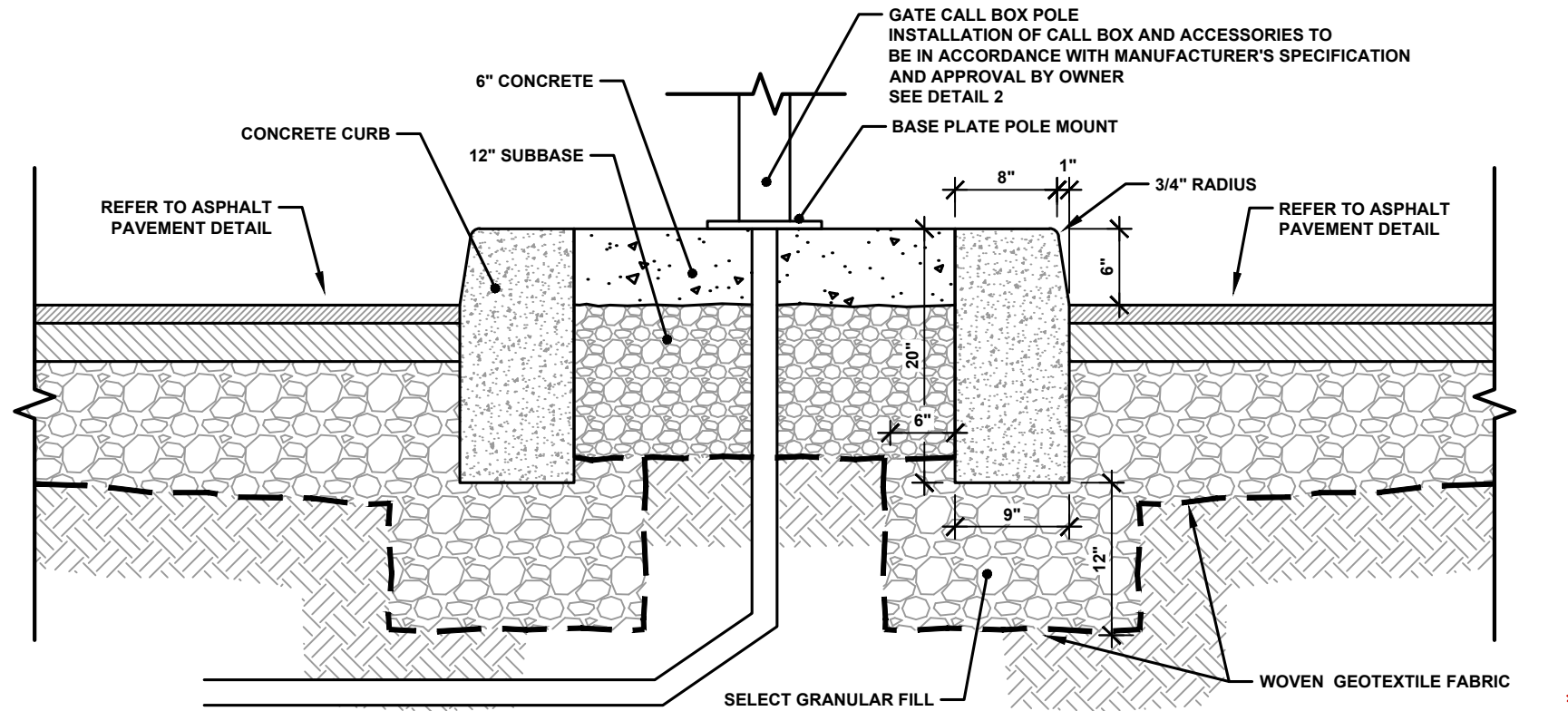

SECTION A-A

1. CONCRETE CALL BOX ISLAND DETAIL
NOT TO SCALE

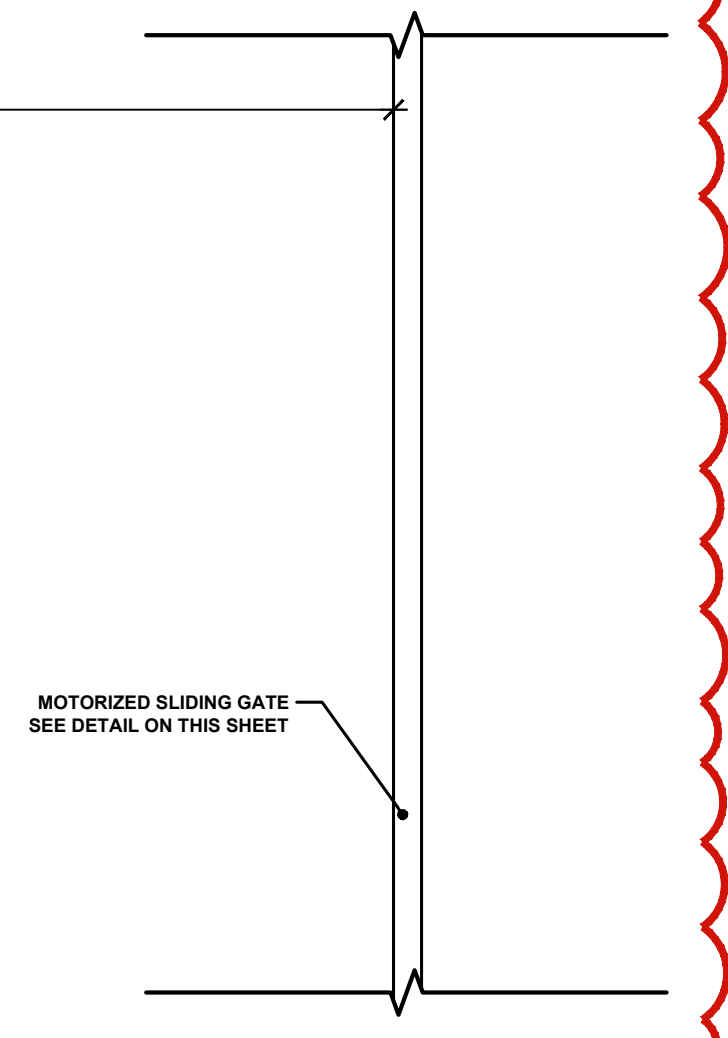

SECTION B-B

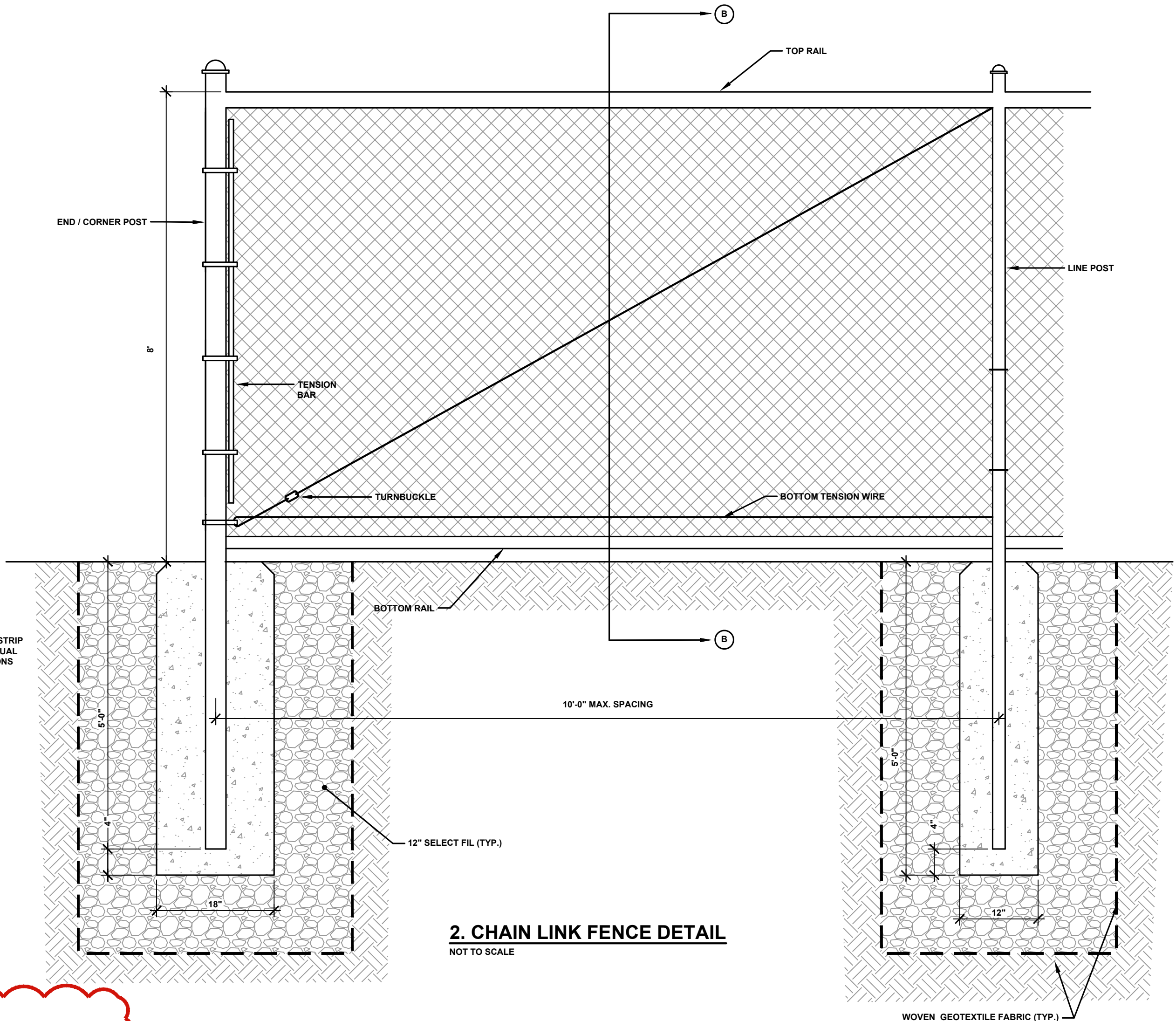
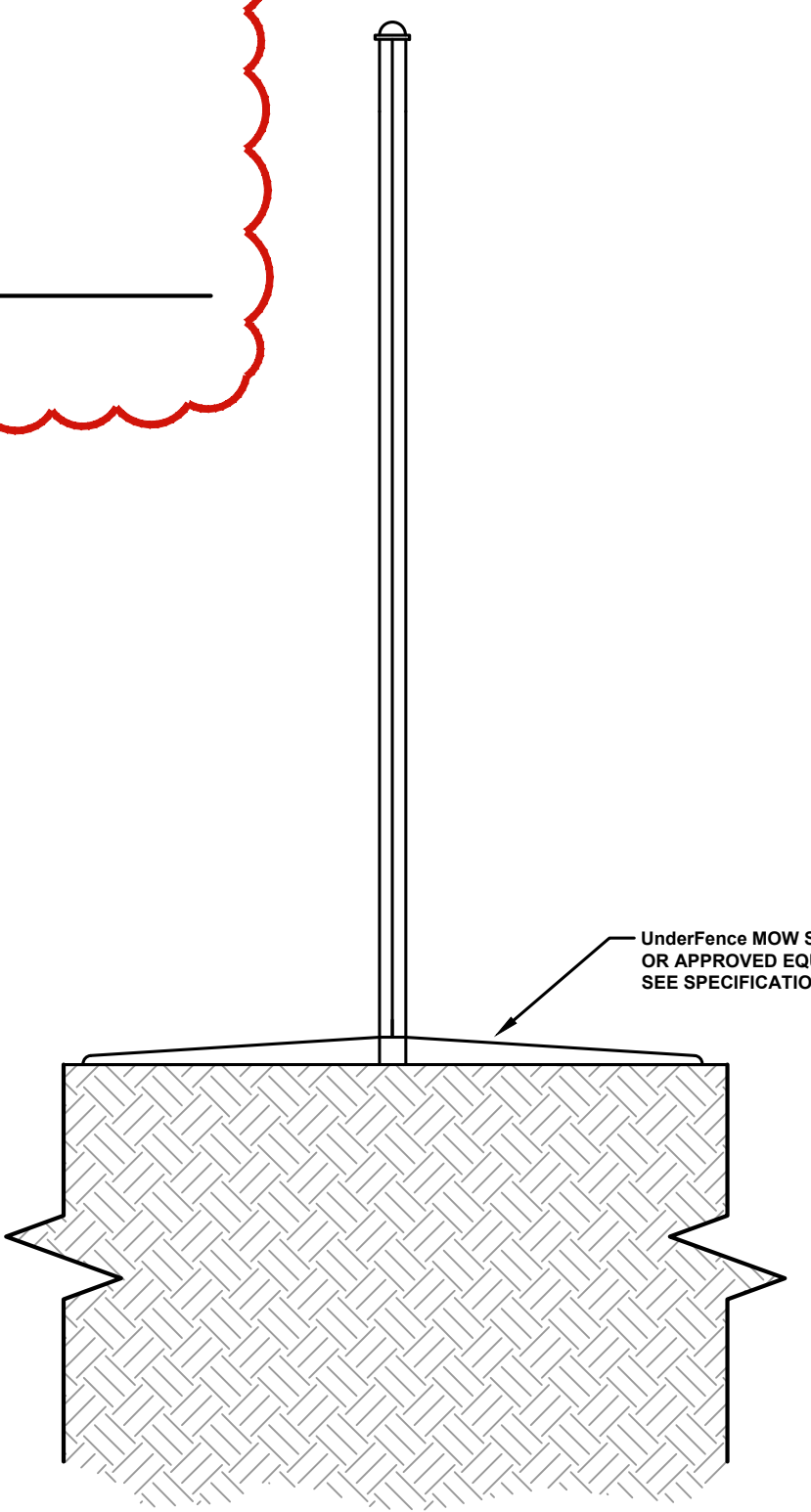

2. CHAIN LINK FENCE DETAIL
NOT TO SCALE

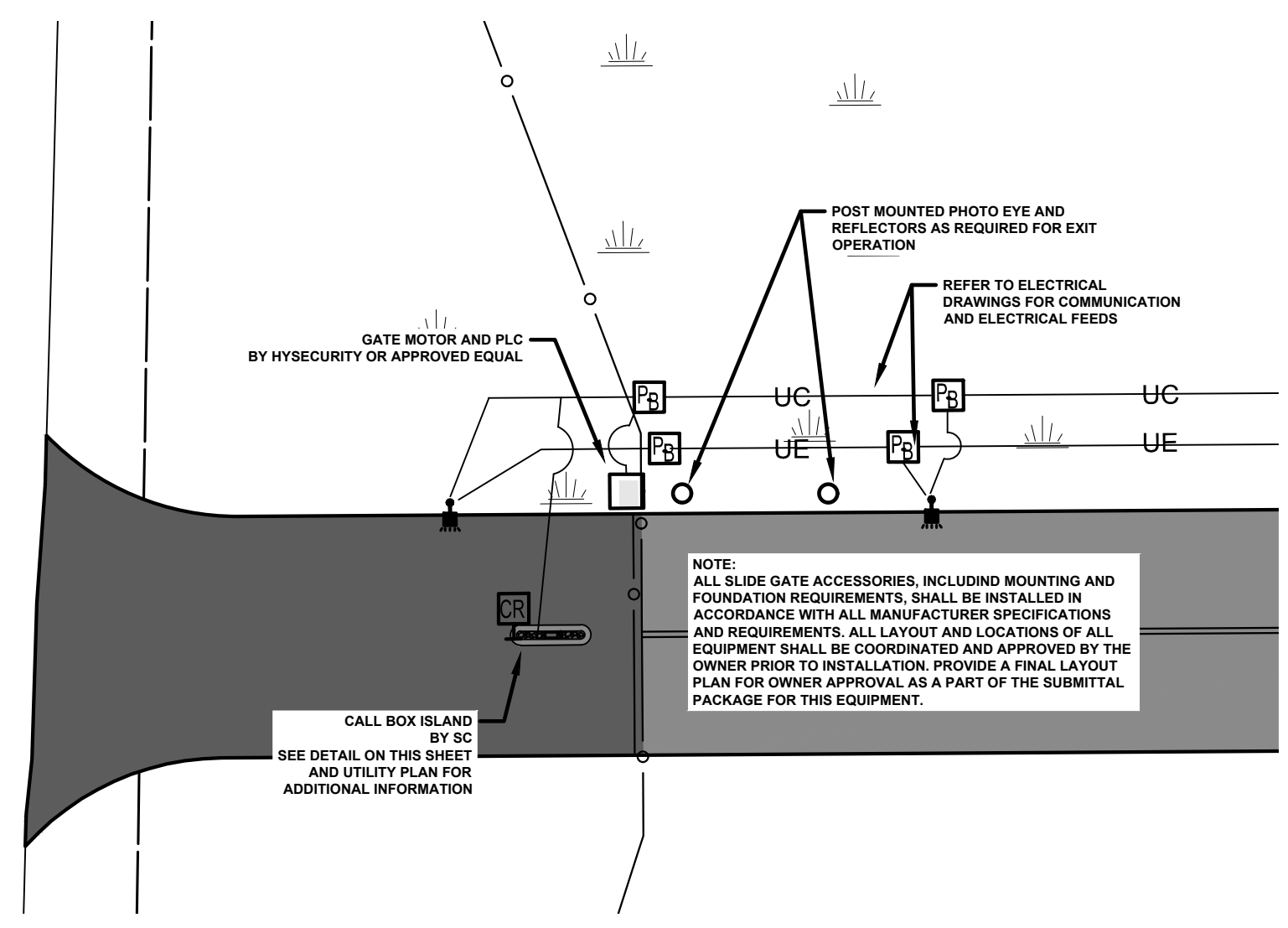

4. MOTORIZED GATE LAYOUT PLAN
NOT TO SCALE

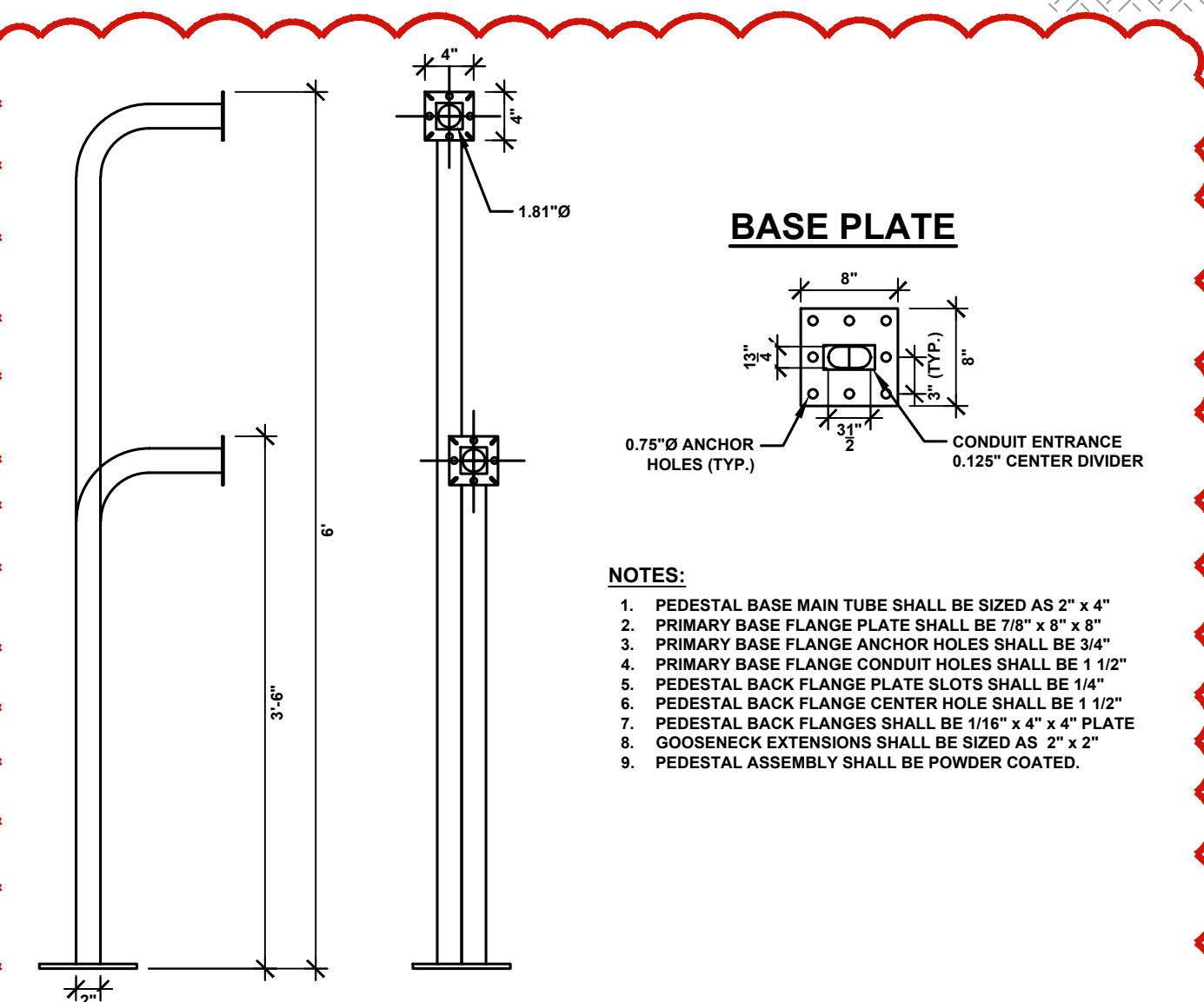

5. CALL BOX MOUNT POLE DETAIL (PROVIDED BY DAY AUTOMATION)
NOT TO SCALE

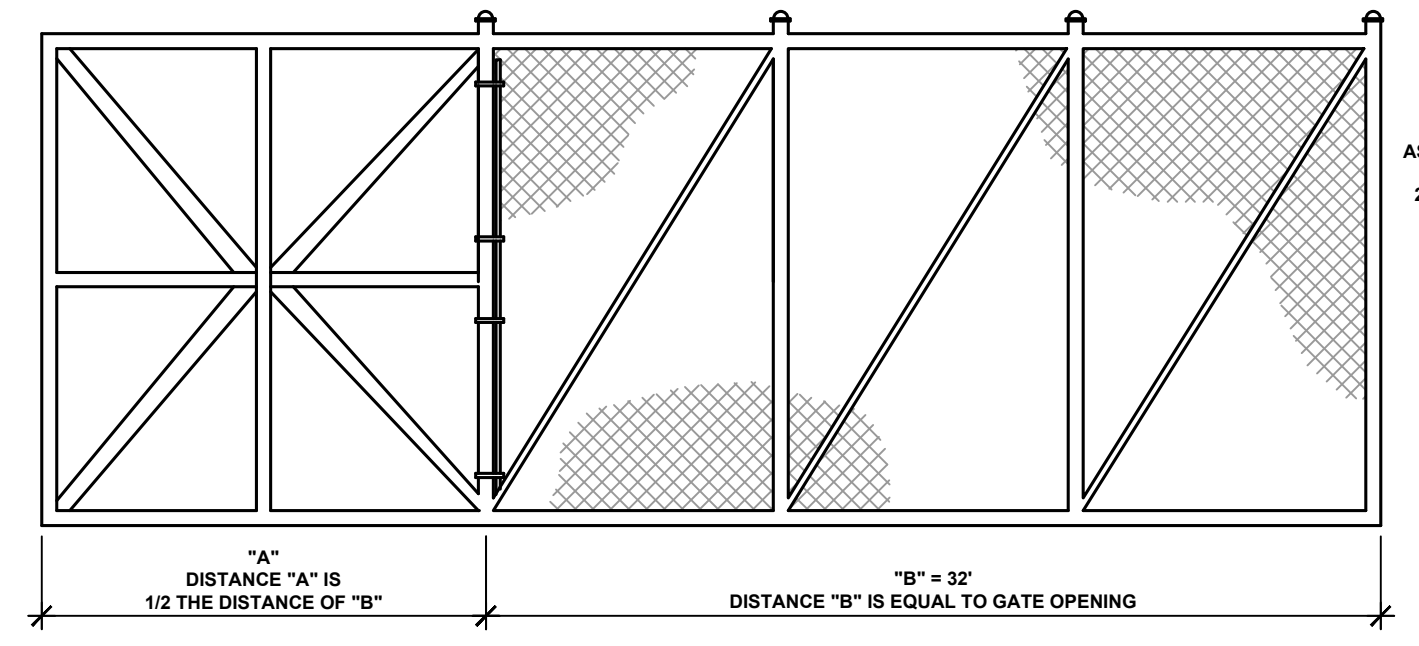

3. MOTORIZED SLIDING CANTILEVER GATE DETAILS
NOT TO SCALE

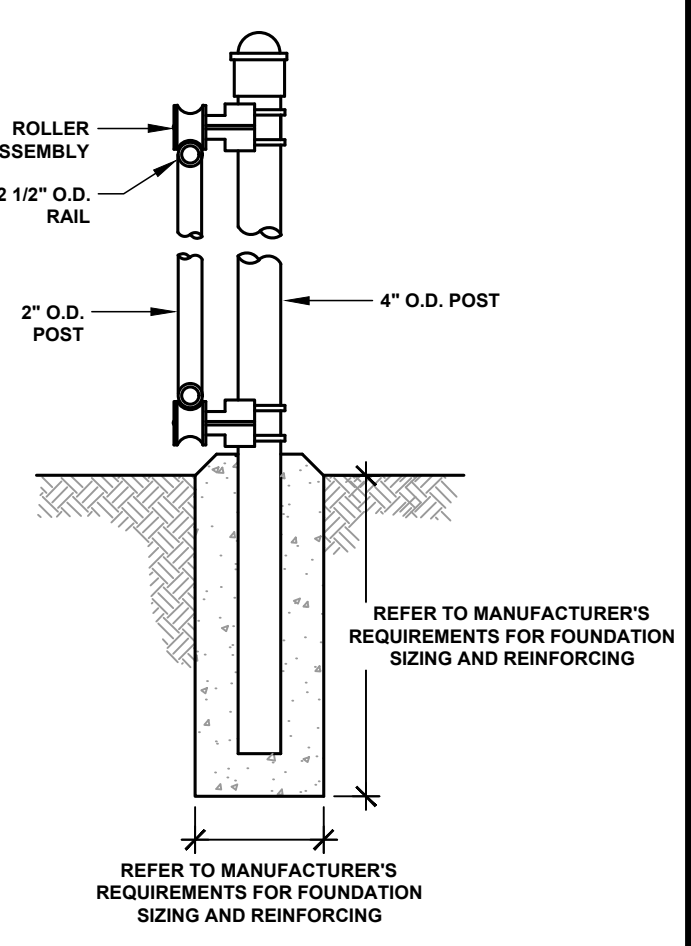

SPECIFICATIONS
TOP AND BOTTOM MEMBERS - 2 1/2" O.D. SCHED. 40 GALV. PIPE
UPRIGHT MEMBERS - 2" O.D. SCHED. 40 GALV. PIPE
HORIZONTAL AND DIAGONAL BRACES - 3/8" O.D. SCHED. 40 GALV. PIPE
REFER TO SPECIFICATION 32 3113

SED CONTROL NO. 51-23-00-01-5-022-001
THIS SHEET INCORPORATES COLOR GRAPHICS WHICH INDICATE IMPORTANT INFORMATION AND SHALL BE PRINTED IN COLOR IF REPRODUCED BY A CONTRACTOR.

BCA Architects & Engineers
Ithaca | Saratoga Springs | Watertown
WWW.THEBCAGROUP.COM
COPYRIGHT © 2023 BCA ARCHITECTS & ENGINEERS, WARNING - IT IS A VIOLATION OF THE NEW YORK STATE EDUCATION LAW FOR ANY UNAUTHORIZED ALTERATIONS TO THIS DOCUMENT AS PER ARTICLE 143 AND 147

BCA ARCHITECTS & ENGINEERS



OGDENSBURG CITY SCHOOL DISTRICT
CAPITAL IMPROVEMENTS PROJECT - PHASE 1
NEW TRANSPORTATION FACILITY
OGDENSBURG - ST. LAWRENCE - NEW YORK

REV	DATE	DESCRIPTION
1	01/03/2025	SED ADD. NO. 1
2	03/05/2025	BID ADD. NO. 3
3	12/18/2025	JC-14 ENTRANCE REVISIONS

DRAWN BY AFF	PROJECT NUMBER 2022-014A
CHECKED BY MDA	DATE 02/28/2025

STANDARD SITE DETAILS

BUILDING	SHEET NUMBER
JC-14	2
	AD3/C-601

JC-14

2

AD3/C-601

SEISMIC REQUIREMENTS

ELECTRICAL CONTRACTOR SHALL PROVIDE SEISMIC RESTRAINT OF NON-STRUCTURAL COMPONENTS AND EQUIPMENT IN ACCORDANCE WITH THE REQUIREMENTS OF STANDARD ASCE-7 BASED ON A SEISMIC DESIGN CATEGORY D AND IMPORTANCE FACTOR OF 1.0.

ELECTRICAL CONTRACTOR SHALL BE RESPONSIBLE FOR PROVIDING THE SERVICES OF A PROFESSIONAL STRUCTURAL ENGINEER TO EVALUATE SEISMIC DESIGN FORCES AND PROVIDE SEISMIC RESTRAINT DESIGNS FOR ALL INSTANCES WHERE STANDARD ASCE-7 EXCEPTIONS ARE NOT MET.

SEE SPECIFICATION SECTION 26 0546 FOR ADDITIONAL INFORMATION.

ITEM	WIRE SIZE	CONDUIT SIZE
A	3-#8-1#10G	1 1/2" RGS
B	2-#6-1#10G	1 1/2" SCHEDULE 80 PVC
C	2-#4-1#8G	1 1/2" SCHEDULE 80 PVC
D	2-#2-1#6G	1 1/2" SCHEDULE 80 PVC
E	SPARE CONDUIT W/ PULL STRING	2" SCHEDULE 80 PVC
F	SPARE CONDUIT W/ PULL STRING	2" RGS
G	2-#10-1#10G	1" RGS
H	4 SETS 4-#500 W/ 1-#10G	(4) 4" RGS
I	3-#2 COPPER HIGH VOLTAGE	(2) 4" RGS
J	8 STRAND ARMORED OS2 INDOOR/OUTDOOR	2" SCHEDULE 80 PVC
K	CAT. (3) 6E DATA DROP	1" RGS
L	3-#4-1#8G	1 1/2" SCHEDULE 80 PVC
M	3-#4-1#8G	2" RGS

- GENERAL NOTES:**
- SEE DRAWING ES000 FOR APPLICABLE GENERAL NOTES, ABBREVIATIONS, SYMBOLS AND LEGENDS.
 - EC TO COORDINATE ALL UNDERGROUND UTILITIES WITH SC AND GC PRIOR TO INSTALLATION.
- SITE PLAN SHEET NOTES**
- ALL LIGHTING AND POWER CONDUCTORS SHALL BE INSTALLED BETWEEN 24" (MINIMUM) AND 36" (MAXIMUM) BELOW FINISHED GRADE.
 - ALL COMMUNICATIONS CONDUIT AND CABLES SHALL BE INSTALLED 36" (MINIMUM) BELOW FINISHED GRADE.
- KEYNOTE LEGEND**
- CIRCUIT EXTERIOR LIGHTING THROUGH LIGHTING CONTRACTOR AND THEN TIME CLOCK IN STORAGE RM 107.
 - LIGHT FIXTURES TO BE ANGLED UP 40 DEGREES FROM HORIZONTAL.
 - PROVIDE CIRCUIT AND CONNECTION DEDICATED FOR TANK MONITORING SYSTEM, FUEL MANAGEMENT SYSTEM AND CANOPY LIGHTING CONNECTIONS. CIRCUIT TO CONTROL PANEL IN DISPATCH RM 101A. COORDINATE WITH SC FOR FINAL LOCATIONS OF EQUIPMENT PRIOR TO INSTALLATION.
 - PROVIDE CIRCUIT AND CONNECTION DEDICATED FOR OIL WATER MONITOR SYSTEM AND OIL WATER TANK ALARM SYSTEM. CIRCUIT TO CONTROL PANEL IN DISPATCH RM 101A. COORDINATE WITH SC FOR FINAL LOCATIONS OF EQUIPMENT PRIOR TO INSTALLATION.
 - PROVIDE CIRCUIT AND CONNECTION DEDICATED FOR FIRE SUPPRESSION SYSTEM AT PUMP STATION. COORDINATE WITH SC FOR FINAL LOCATIONS OF EQUIPMENT PRIOR TO INSTALLATION.
 - PROVIDE CIRCUIT AND CONNECTION DEDICATED FOR FUEL DISPENSER. COORDINATE WITH SC FOR FINAL LOCATIONS OF EQUIPMENT PRIOR TO INSTALLATION.
 - PROVIDE PULLBOX AT LOCATION SHOWN. PROVIDE PULLBOX COVER WITH "ELECTRIC" TYPICAL FOR ALL SHOWN IN SERIES.
 - PROVIDE PULLBOX AT LOCATION SHOWN. PROVIDE PULLBOX COVER WITH "COMMUNICATIONS" TYPICAL FOR ALL SHOWN IN SERIES.
 - CONTRACTOR TO ROUTE ELECTRICAL SERVICE IN DEDICATED CHASE UP TO SECOND FLOOR ELECTRICAL ROOM UNDER MDP. REFER TO E100 AND ONE-LINE DIAGRAM FOR ADDITIONAL INFORMATION.
 - ALL CONDUITS UNDER ASPHALT TO BE RGS CONDUIT ONCE TO PULL BOX AND IN GRASS AREA PVC CAN BE USED.
 - ALL FITTINGS, CONNECTORS, BOXES AT FUEL STATION TO BE CLASS 1 DIVISION 1 EXPLOSION PROOF.
 - PROVIDE (3) CATEGORY 6E UTP PLENUM RATED DATA DROP AND CONNECTIONS FROM LOCATION SHOWN TO (3) IN STORAGE RM 107. TYPICAL ALL DATA DROPS.
 - PROVIDE A CORNING PRODUCT NUMBER 0082P-31131-29 SINGLE MODE 6 STRAND (SS) PLENUM RATED INDOOR/OUTDOOR FIBER OPTIC CABLE FROM BUS GARAGE MDP TO NETWORK SWITCH PROVIDED BY DAY AUTOMATION. THEN PROVIDE CATEGORY 6E WIRING FROM NETWORK SWITCH TO CAMERAS AND CARD READER LOCATION. PROVIDE FIBER OPTIC PATCH PANELS ON BOTH ENDS AND TERMINATE ALL FIBER WITH LC CONNECTORS. ALL FIBER TO BE TESTED.

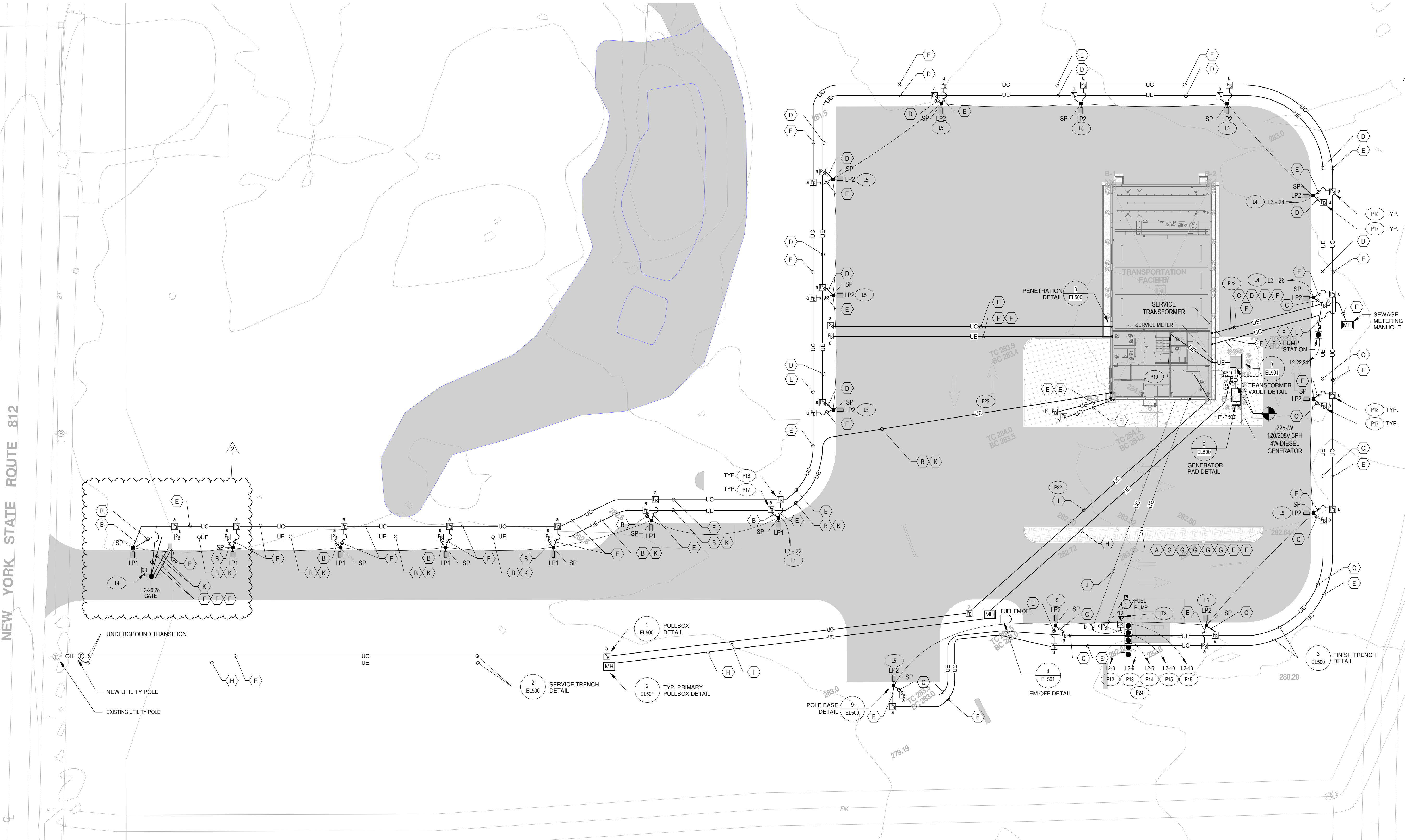

KEY PLAN: FIRST FLOOR

KEY PLAN
SCALE: NTS

SED NO. 51-23-00-01-5-022-001

COPYRIGHT © 2024, BCA ARCHITECTS & ENGINEERS, WARREN, - IT IS A VIOLATION OF THE NEW YORK STATE EDUCATION LAW FOR ANY UNAUTHORIZED ALTERATIONS TO THIS DOCUMENT AS PER ARTICLE 145 AND 147.

BCA Architects & Engineers
Watertown | Ithaca | Saratoga Springs
Rochester | Troy | Binghamton | Syracuse
WWW.THEBCAGROUP.COM

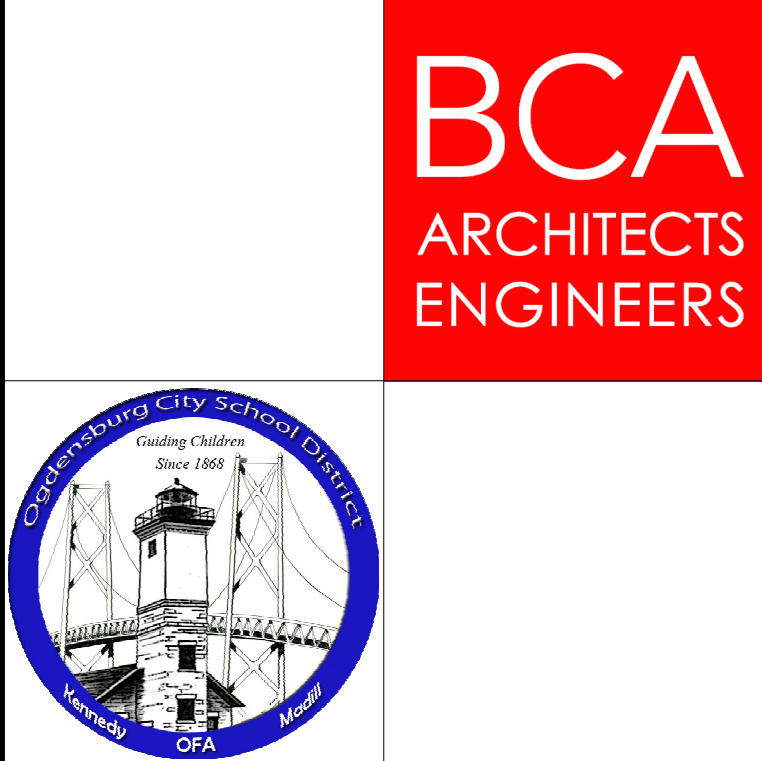

OGDENSBURG CITY SCHOOL DISTRICT
NEW TRANSPORTATION BUILDING
CAPITAL IMPROVEMENTS PROJECT - PHASE 1
Ogdensburg - St. Lawrence - New York

REV	DATE	DESCRIPTION
1	12/18/2025	JC-14

DRAWN BY	PROJECT NUMBER
SMG	2022-014A
CHECKED BY	DATE
SGV	02/07/2025

ELECTRICAL SITE PLAN

BUILDING NUMBER	SHEET NUMBER
JC-14	2

1 ELECTRICAL SITE PLAN
SCALE: 1" = 30'-0"

12/18/2025 9:33:42 AM

April 22, 2026

Kevin Kendall
Superintendent
Ogdensburg CSD

Re: Change Order to Job 25-3044 – Gate Control Addition to Bus Garage
Estimate: EST-026504

Dear Mr. Kendall,

Day Automation is pleased to provide the following proposal, as specified for your review and approval.

Project Summary: Day Automation is proposing the following gate control modifications & additions.

Scope of Work – Bus Garage

- Furnish and install access control for (1) lane of drive in and out gate entrance to include:
 - (1) Dual head pedestal
 - (2) 8016 Axis video intercoms w/ integrated card readers
 - (1) 2x8MP Exterior Dual-Head Camera – Pendant Wall Mount
 - Fiber Panel(s) for connection between gate and building
 - (1) access control panel to tie gate system into existing access control
 - **All Gate control terminations by gate control integrator**

Network Clarifications and Exclusions:

- This project will need **open network ports** provided by the customer.
- **All network switch/ switches furnished and installed by customer**
- Management of network switches by the customer
- All network connectivity and static IP addresses will be provided by the customer.
- All rack space and power requirements for head end provided by the customer.

Scope Clarifications and Exclusions:

- All required system programming, testing, and system commissioning performed by Day Automation.
- All cable furnished and installed by Day Automation unless specified above otherwise
- All building side network switch/ switches furnished and installed by customer
- Management of network switches by the customer
- All network connectivity and static IP addresses will be provided by the customer.
- All field terminations by Day automation
- All camera terminations by Day Automation
- All gate hardware by customer
- All required 120vac for system power requirements will be furnished by the customer.
- All work to be performed during regular business hours (7:00AM to 3:30PM, Monday – Friday, excluding holidays).
- Day Automation technicians assume either free access or escorted access to all required areas of the facility during the installation.
- Includes 1-year warranty. Warranty does not apply to existing equipment/cable.
- Prices quoted herein will be honored for a period of 30 days.
- The customer is responsible for any permits, fees as required.
- Not included
 - Performance and Payment Bond
 - Demolition, painting, patching and sound caulking
 - Contingency for unforeseen circumstances
 - Gate repairs or gate actuators
 - Hazardous material abatement
 - Sales or use tax
 - Premium time

System Engineering to include the following:

- Submittals to include site specific riser diagrams, termination details, floor plans showing device locations and spec sheets. Day Automation requires the customer to furnish facility drawings in order to provide system As-Built drawings.
- Warranty, Close-Out Documentation.

Project management / Field Implementation:

- Programming.
- Field testing.
- User Training

Pricing Summary:

	Non-NYSC Material	NYSC Material	Technical Services	Expenses/Subs	Total
Bus Garage Gate	\$7,116.51	\$7,955.60	\$9,901.25	\$16,605.00	\$41,578.36
Totals	\$7,116.51	\$7,955.60	\$9,901.25	\$16,605.00	\$41,578.36

Project Cost.....\$41,578.36

Includes \$7,116.51 in non-NYSC equipment.

Please be advised that this proposal was prepared and is in accordance with the requirements of Day Automation Systems' NYS OGS contract PT-68783. Day Automation and all Day Automation subcontractors have quoted labor rates at or below the posted prevailing wage rates per Day Automation's OGS contract PT-68783 requirements.

This proposal has been prepared prior to final project engineering and design. As such, the selection of the equipment is preliminary and may change based upon project design. Technical Services and installation may also change as a function of these modifications however the project pricing is firm and fixed unless these adjustments ultimately result in an overall lower cost for the project. The project will be progress billed monthly.

Please contact me if you have any questions or would like additional information.

Sincerely,

Day Automation by Stark Tech®

Brian Bujnowski

Account Executive

315.323.2416 | Ogdensburg, NY



Bus Garage Gate						
NYSC	Qty	Manufacturer	Model	Description	Unit Sell	Ext. Sell
NYSC	1	Altronix	OLS75	OFFLINE SWITCHING PS, 115VAC,12/24 VDC OUT @2.5A, W/AC FAIL & LOW BATT ALARM	\$103.04	\$103.04
NYSC	1	Altronix	PD4	4 Fused Output Power Distribution Module	\$27.18	\$27.18
NYSC	1	AMG Systems	AMG210M-1G-1S	Commercial Media Converter, 1x1Gb RJ45 Port, 1x1Gb SFP Port, Mini, PS Incl, SFP Not Incl	\$146.89	\$146.89
NYSC	1	AMG Systems	AMG570-2GBT-2GAT-2S-P240	Ind 6-Port Managed Switch, 4x1Gb RJ45, 2x90W / 2x30W (240W Max), 2x2.5Gb SFP, DIN/Wall Mount, 52-56Vdc In	\$1,372.45	\$1,372.45
NYSC	1	AMG Systems	AMGPSU-I48-P240A-IEC	52Vdc 240W Ind Power Supply, DIN-Rail Mount, IEC Mains In, Fault Rly, Acc Inc	\$314.75	\$314.75
NYSC	2	AMG Systems	SFP-SM-2.5G-LX20-31	SFP Singlemode, 2.5Gb, 2 Fibers, 20Km (12mi), LC Connectors, 1310nm Tx/Rx, DDM	\$126.68	\$253.36
NYSC	1	Avigilon	AC-MER-CONT-MP1502	2-Door Intelligent Controller, 8 In, 4 Relay Outputs, 12-24Vdc, RS485	\$1,402.56	\$1,402.56
NYSC	1	Avigilon	UNITY8-ENT	UV8 Enterprise Camera License	\$277.31	\$277.31
NYSC	1	Avigilon	WLMT-1021	Pendant Wall Mount Arm for Dome Cameras, 1.5" NPT	\$92.00	\$92.00
NYSC	2	Axis	01995-001	I8016-LVE IP Video Intercom, 5MP, Stainless Steel, IK10, 2-gang	\$1,151.40	\$2,302.80
NYSC	2	Axis	02066-001	TI8602 Wall Mount for I8016-LVE IP Video Intercom, IK10, IP69, Black	\$152.69	\$305.38
NYSC	2	Axis	02233-001	TI8603 3/4" NPS Conduit Adapter for TI8602 Wall Mount	\$32.65	\$65.30
NYSC	2	Axis	02861-001	A9210 Network I/O Relay Module, 2x I/O, 5x input, 3x out, 1x form C relay, 1x RS485, PoE+/12VDC	\$306.34	\$612.68
NYSC	2	Corning	CCH-CP06-A9	Closet Connector Housing (CCH) Panel, LC Adapters, Duplex, UPC, 6 F, Single-mode (OS2)	\$70.17	\$140.34
NYSC	2	Corning	SPH-01P	Single-Panel Housing (SPH), Wall Mount, Holds 1 CCH-CP, Black	\$83.50	\$167.00
NYSC	3	Ditek Corp.	DTK-MRJP0ES	STP PoE Surge Protector, RJ45, 75V Clamp, Ground Screw	\$69.60	\$208.80
NYSC	2	Leviton	41089-1WP	Surface Mount QuickPort Box, Plenum Rated, 1-Port, White	\$2.45	\$4.90
NYSC	2	Leviton	6110G-RW6	eXtreme Cat 6A QuickPort Jack, Channel-Rated, White	\$17.13	\$34.26
NYSC	4	LYNN	CAT6A-01-ORB	1' CAT6A CHOICE 10Gb UTP Patch Cable, 24AWG, Molded Boot, Orange	\$6.50	\$26.00
NYSC	1	LYNN	CAT6A-03-ORB	3' CAT6A CHOICE 10Gb UTP Patch Cable, 24AWG, Molded Boot, Orange	\$7.94	\$7.94
NYSC	1	LYNN	CAT6A-10-ORB	10' CAT6A CHOICE 10Gb UTP Patch Cable, 24AWG, Molded Boot, Orange	\$15.01	\$15.01
NYSC	2	LYNN	CAT6A-25-ORB	25' CAT6A CHOICE 10Gb UTP Patch Cable, 24AWG, Molded Boot, Orange	\$29.95	\$59.90
NYSC	1	Powersonic	PS-1270 F1	12 Vdc 7 AH Battery	\$15.75	\$15.75
FMV	1	Avigilon	16.0C-H6ADH-DO1-IR	2x8MP H6A Outdoor IR Dual Head with 3.24-7.33mm Lens	\$1,997.89	\$1,997.89
FMV	1	Avigilon	NPTA-1201	Pendant NPT Adapter	\$65.05	\$65.05
FMV	1	FIS	X9LULUS1FISCU	1m Duplex 1.6mm SM SMF-28 Ultra Fiber LC/UPC To LC/UPC, Yellow	\$17.03	\$17.03
FMV	1	FIS	X9LULUS2FISCU	2m Duplex 1.6mm SM SMF-28 Ultra Fiber LC/UPC To LC/UPC, Yellow	\$17.55	\$17.55
FMV	1	L-com	HGX-PMT28	Enclosure Pole Mount for Pole Diameters of 4-7"	\$218.99	\$218.99
FMV	2	L-com	NB201611-1HFS	20x16x11" 120Vac FRP Weatherproof Enclosure w/Solid State Fan & Heat Ctrl, N3R/IP24, Gray	\$2,400.00	\$4,800.00

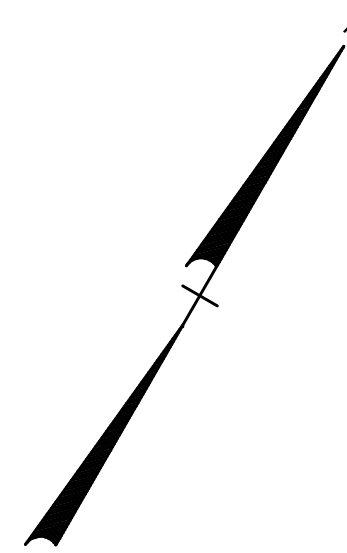
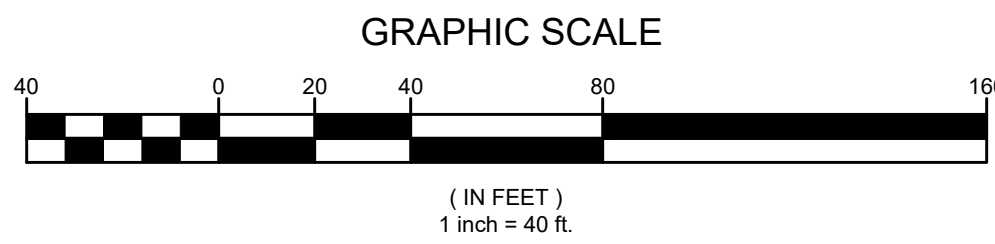

NOTES:

1. INCLUDE THE FOLLOWING: 11'-2" LONG X 16'-4" WIDE X 17'-9" HIGH MEDIUM DUTY MD-12B PORTABLE FLEETFLOW BY SCRAPER SYSTEMS (OR EQUAL) WITH 13'-5" HIGH X 12'-0" WIDE DRIVE-THRU CLEARANCE, 4-SETS OF WHEELS ON SCREW JACKS, TOW BARS, CONCRETE STABILIZING BALLASTS, 12V DC (BATTERY) WEATHER RESISTANT PENDANT CONTROLS, DEEP-V PLOW BLADE ASSEMBLY, NEMA-4 WATER-TIGHT DUST-TIGHT ELECTRICAL ENCLOSURES

NOTE:
THE NYS DOT PERMIT FOR THIS DRIVEWAY IS CURRENTLY UNDER REVIEW WITH NYS DOT. THIS PERMIT IS EXPECTED TO BE ISSUED IN SEPTEMBER 2025 FOR FINAL APPROVAL.

KEY PLAN:

SED CONTROL NO. 51-23-00-01-5-022-001

THIS SHEET INCORPORATES COLOR GRAPHICS WHICH INDICATE IMPORTANT INFORMATION AND SHALL BE PRINTED IN COLOR IF REPRODUCED BY A CONTRACTOR.

BCA Architects & Engineers
Ithaca | Saratoga Springs | Watertown

WWW.THEBCAGROUP.COM
COPYRIGHT © 2023 BCA ARCHITECTS & ENGINEERS. WARNING - IT IS A VIOLATION OF THE NEW YORK STATE EDUCATION LAW FOR ANY UNAUTHORIZED ALTERATIONS TO THIS DOCUMENT AS PER ARTICLE 165 AND 167.

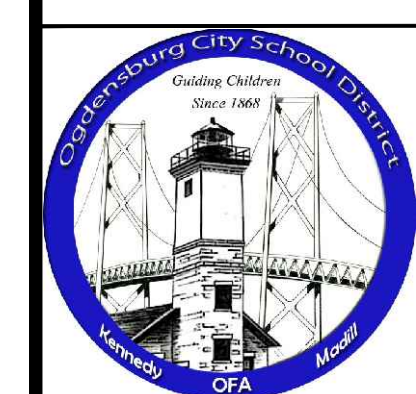
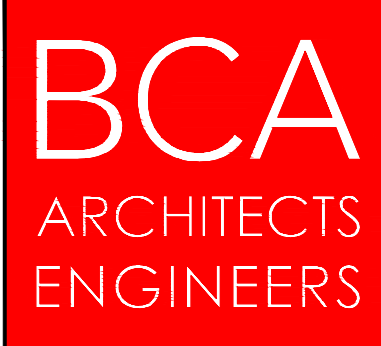

OGDENSBURG CITY SCHOOL DISTRICT
CAPITAL IMPROVEMENTS PROJECT - PHASE 1
NEW TRANSPORTATION FACILITY
OGDENSBURG- ST. LAWRENCE - NEW YORK

REV	DATE	DESCRIPTION
1	01/03/2025	SED ADD. NO. 1

DRAWN BY AFF	PROJECT NUMBER 2022-014A
CHECKED BY MDA	DATE 02/07/2025

SITE PLAN

BUILDING 2	SHEET NUMBER C-100
----------------------	------------------------------

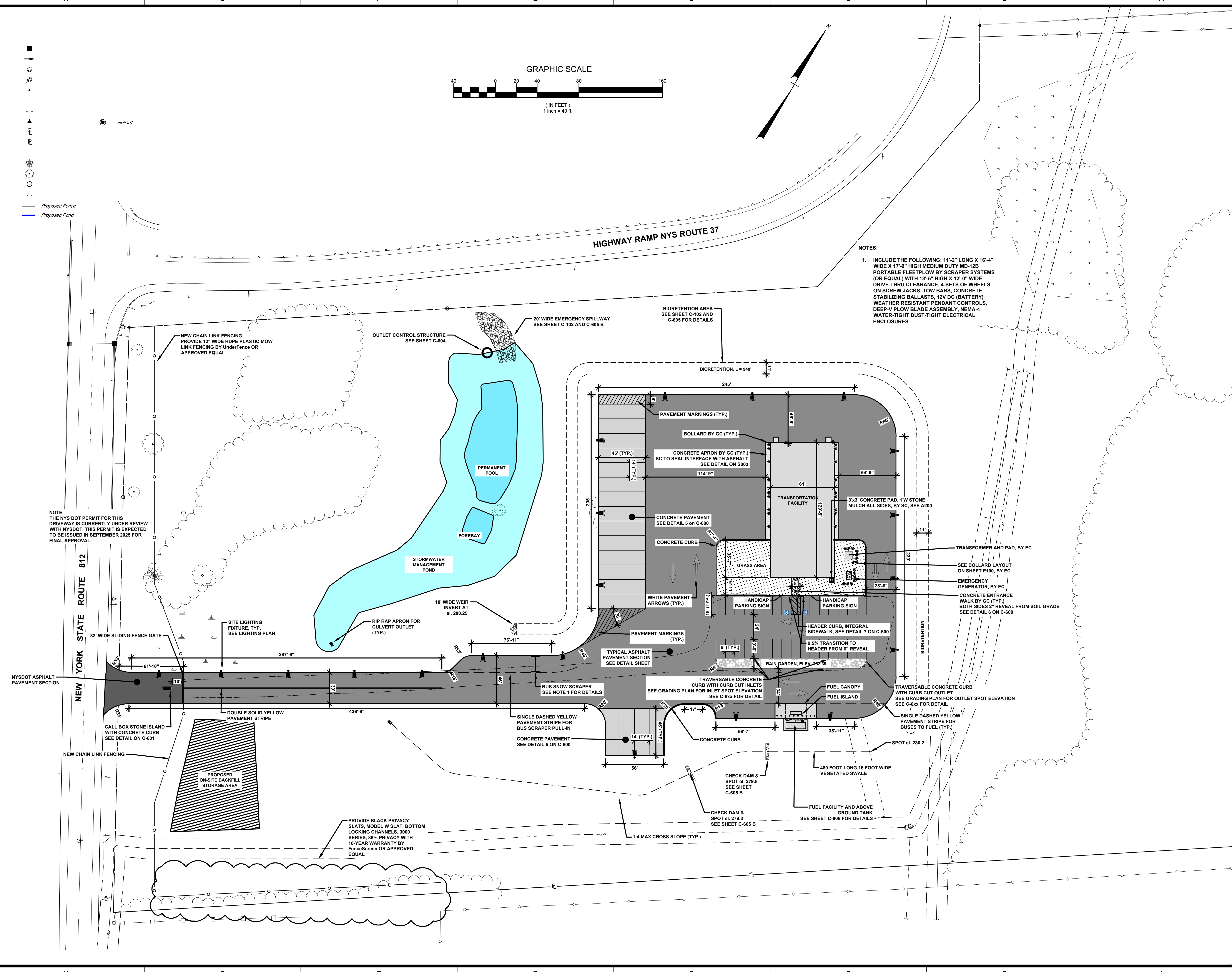

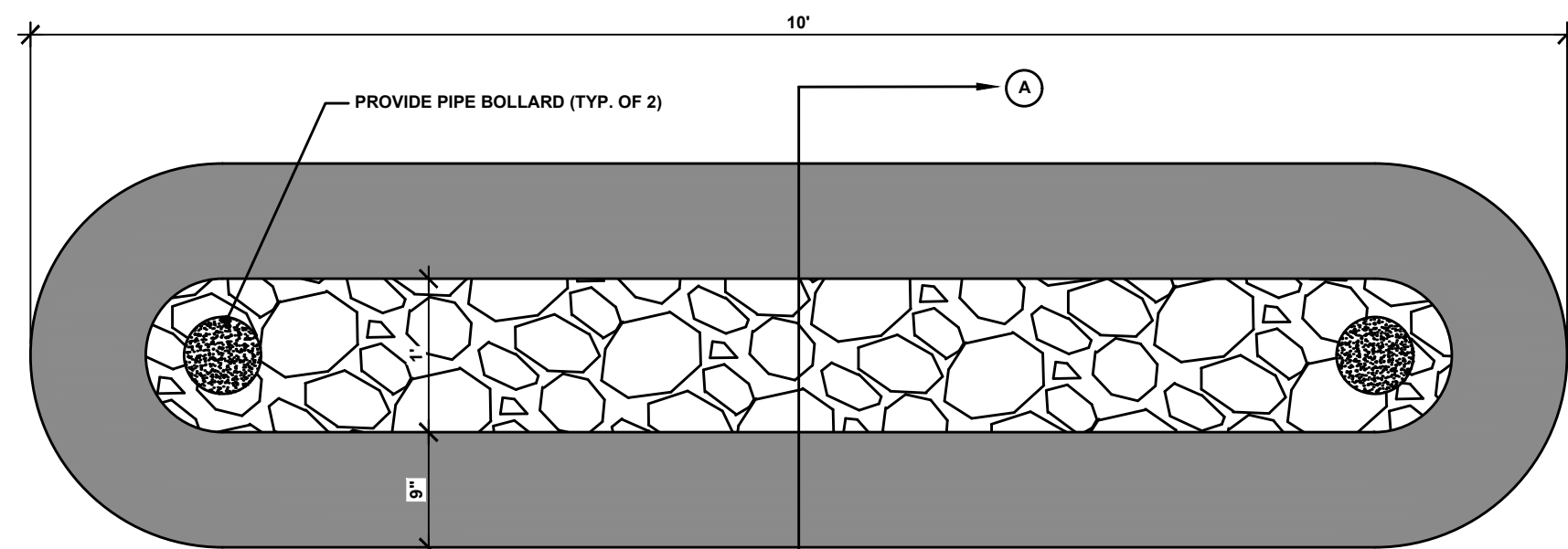

TOP VIEW

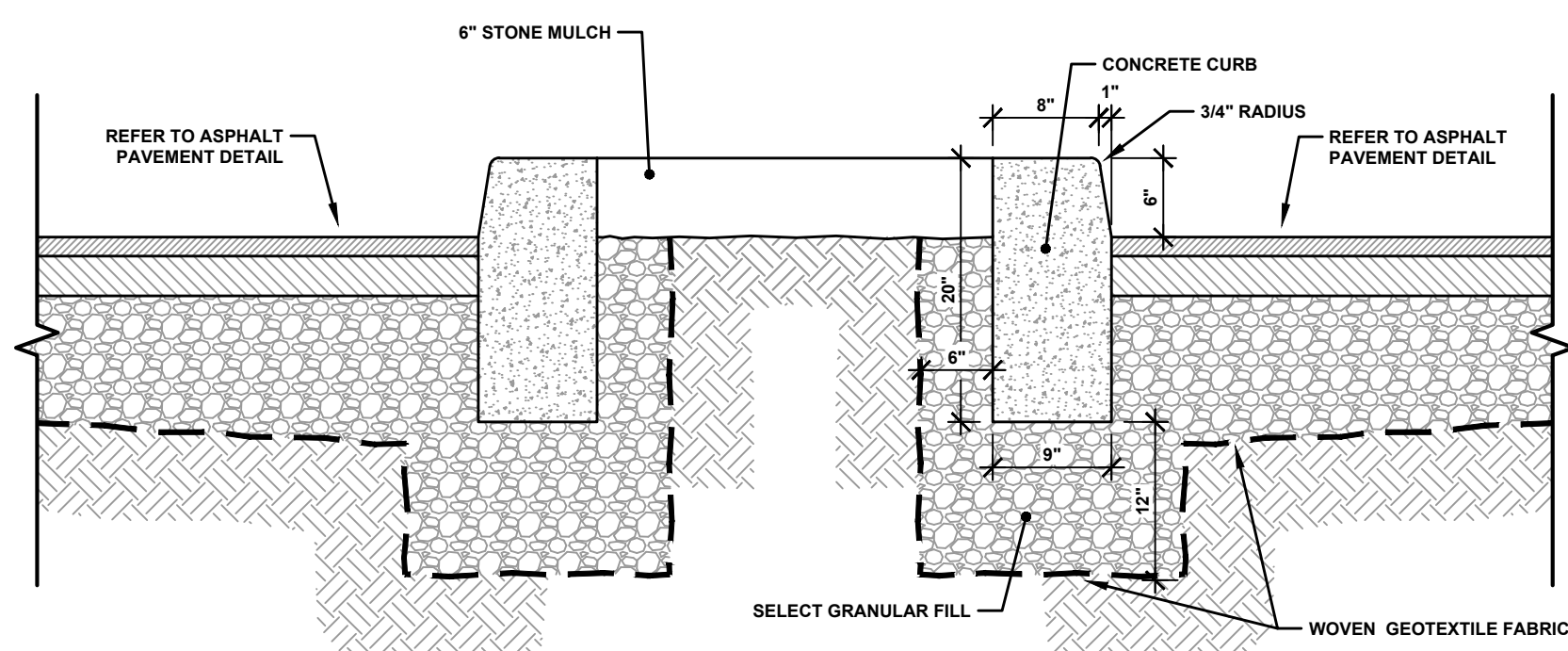

SECTION A-A

1. CONCRETE CALL BOX ISLAND DETAIL
NOT TO SCALE

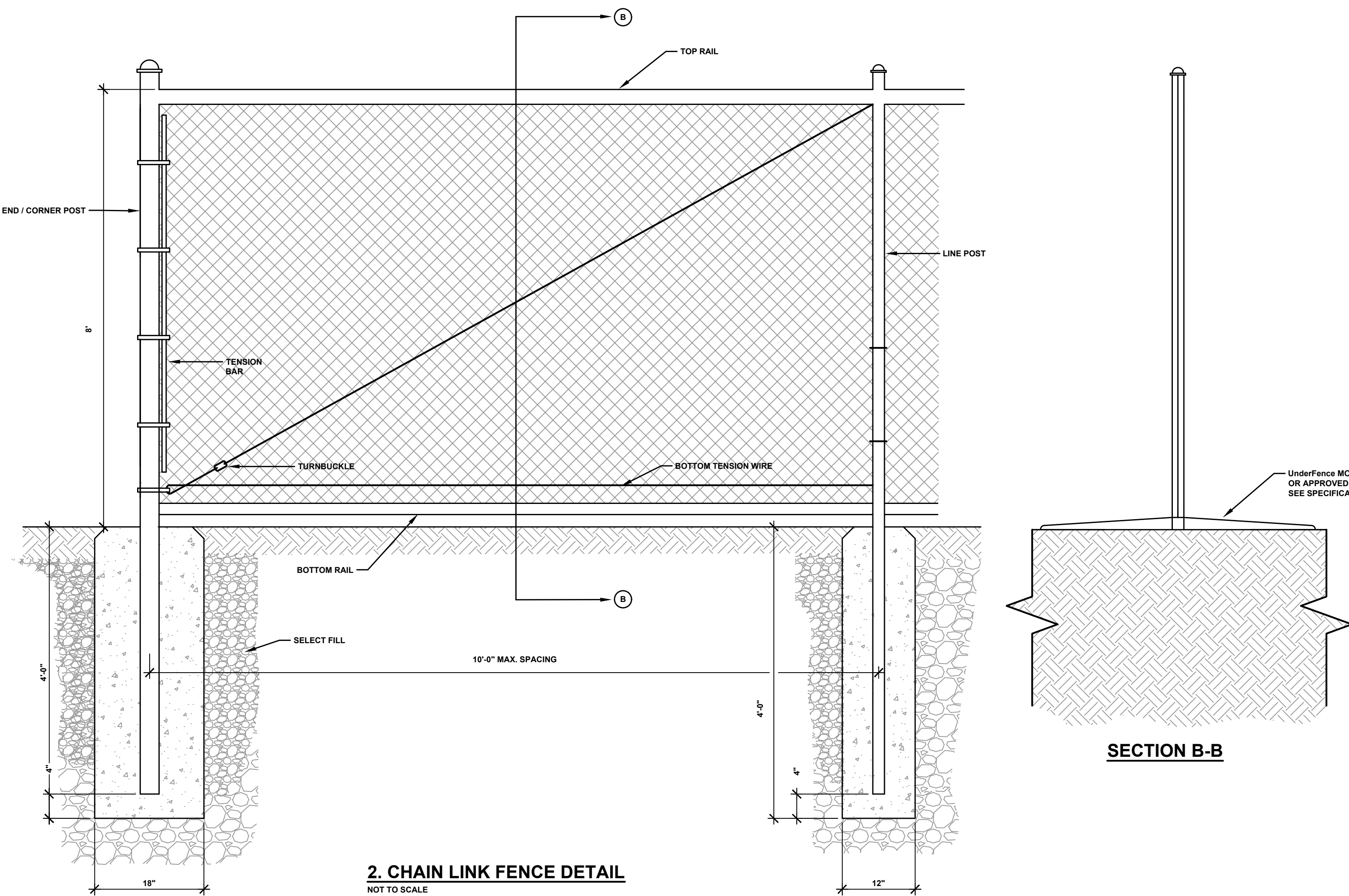

2. CHAIN LINK FENCE DETAIL
NOT TO SCALE

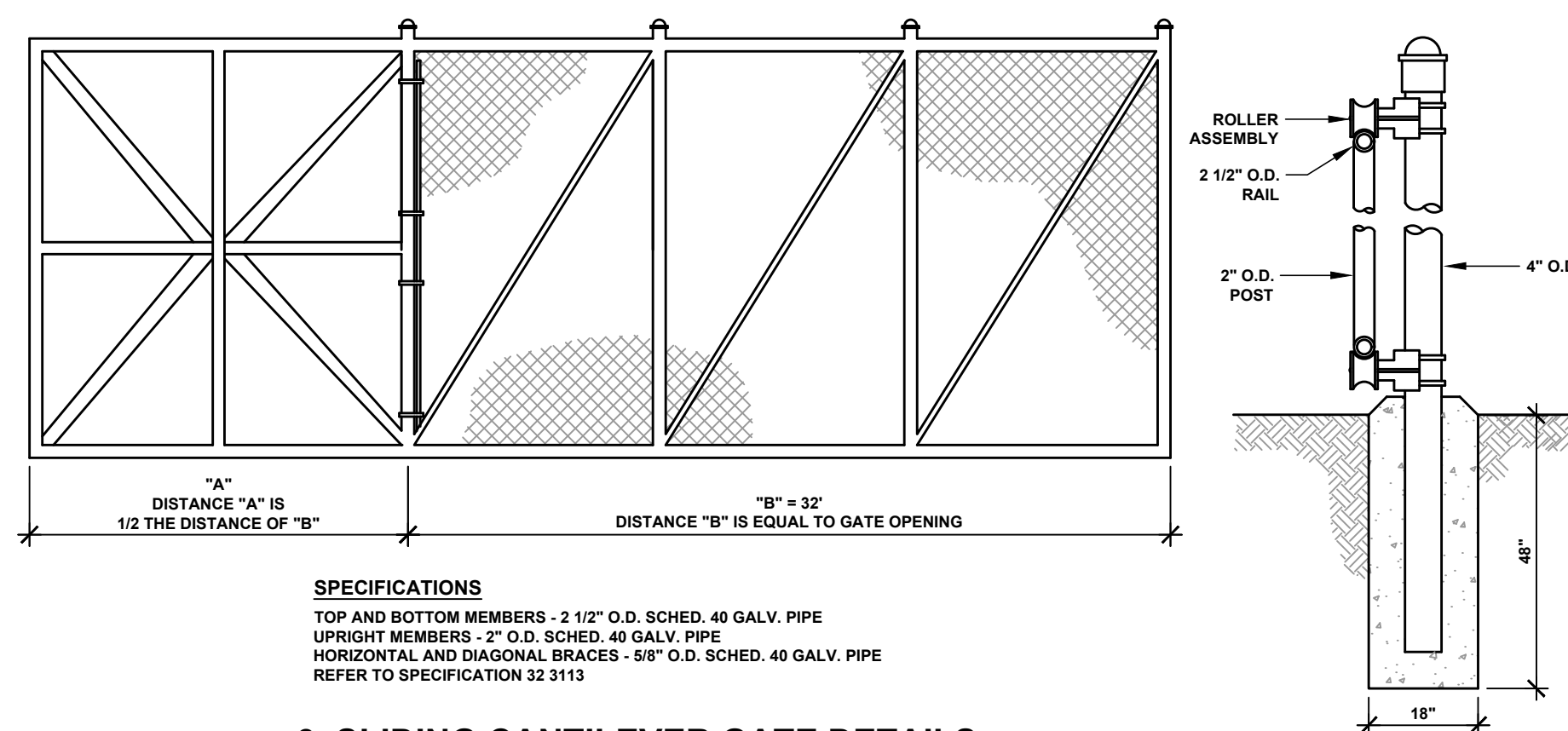

3. SLIDING CANTILEVER GATE DETAILS
NOT TO SCALE

KEY PLAN:

SED CONTROL NO. 51-23-00-01-5-022-001

THIS SHEET INCORPORATES COLOR GRAPHICS WHICH INDICATE IMPORTANT INFORMATION AND SHALL BE PRINTED IN COLOR IF REPRODUCED BY A CONTRACTOR.

BCA Architects & Engineers
Ithaca | Saratoga Springs | Watertown
WWW.THEBCGROUP.COM
COPYRIGHT © 2023 BCA ARCHITECTS & ENGINEERS. WARNING - IT IS A VIOLATION OF THE NEW YORK STATE EDUCATION LAW FOR ANY UNAUTHORIZED ALTERATIONS TO THIS DOCUMENT AS PER ARTICLE 145 AND 147

OGDENSBURG CITY SCHOOL DISTRICT

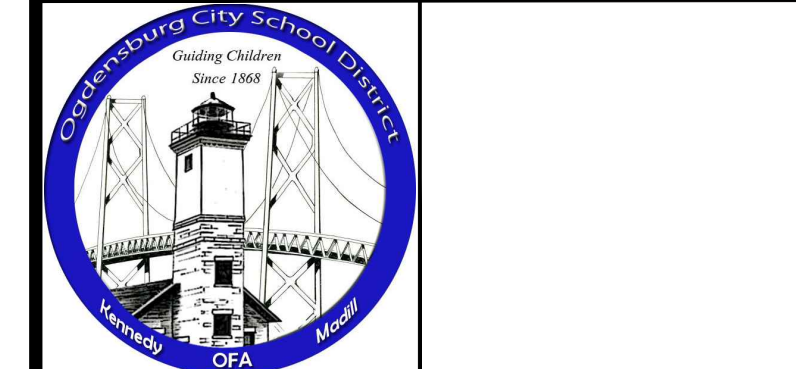
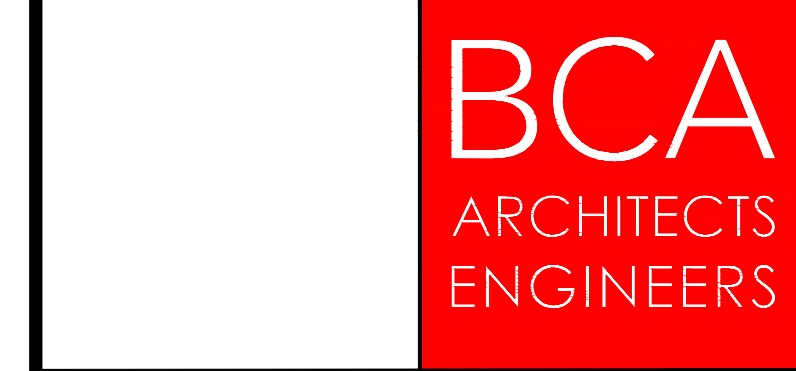

OGDENSBURG CITY SCHOOL DISTRICT
CAPITAL IMPROVEMENTS PROJECT - PHASE 1
NEW TRANSPORTATION FACILITY
OGDENSBURG- ST. LAWRENCE - NEW YORK

REV	DATE	DESCRIPTION
1	01/03/2025	SED ADD. NO. 1

DRAWN BY AFF	PROJECT NUMBER 2022-014A
CHECKED BY MDA	DATE 02/07/2025

STANDARD SITE DETAILS

BUILDING 2	SHEET NUMBER C-601
----------------------	------------------------------



CHANGE ORDER CERTIFICATION

Must be attached to back of Change Order

FP-COC 09/02, rev 08/06,
rev. 04/10

Page One

THE STATE EDUCATION DEPARTMENT

THE UNIVERSITY OF THE STATE OF NEW YORK / Albany, NY 12234

Office of Facilities Planning, Room 1060 Education Building Annex

Tel. (518) 474-3906 Fax (518) 486-5918

www.emsc.nysed.gov/facplan/

Instructions: This CERTIFICATION is required for all change orders submitted to SED
Fill out all three parts completely.

Change Order Number: SC01 - 01
--

Part One - General Information

Provide separate Change Orders for each Project Number

SED Project Number	5	1	2	3	0	0	0	1	5	0	2	2	0	0	1	←
	District BEDS Code							Building Identification Number				Project number				
District & Building Name	Ogdensburg City School District - Transportation Facility															
Type of Project	<input checked="" type="checkbox"/> Reconstruction /Alteration <input type="checkbox"/> Addition & Alteration <input type="checkbox"/> New Building <input type="checkbox"/> Other															
Project Description	Capital Improvements Project - Phase 1															
Architect / Engineer firm	BCA Architects & Engineers					15 Public Square					Watertown, NY 13601					
	name					address										
Contact Person	Shawn M. Travers, R.A. Principal/Architect					(315) 782-8130					stravers@thebcgroup.com					
	name & title					phone number & e-mail										
Construction Manager firm	C&S Engineers, Inc.					499 Col Eileen Collins Blvd					Syracuse NY 13212					
	name					address										
Contact Person	Jessica R. Miller, P.E. Project Manager					(315) 703-4383					jmiller@cscos.com					
	name & title					phone number & e-mail										
District Contact Person	Kevin Kendall, Superintendent of Schools					(315) 393-0900					kkendall@ogdensburgk12.org					
	name & title					phone number & e-mail										

Part Two

Provide the following information for each individual item in the change order:

(Number each item if there is more than one and provide additional sheets as necessary.)

- Requested By** (Who initiated the change request)
- Relationship to Project Scope** (How is this change related to the original project scope)
- Basis of Need** (Describe why the change is needed)
- Description of Work** (Provide a detailed description of the work or services provided in the change order. Provide text, a drawing or both as necessary to demonstrate code compliance and the individual cost of each item.)

A.	Owner Requested.
B.	Under the Capital Project, the new transportation facility was scheduled to receive a sliding gate and call box island to control vehicular access to the site as per Contract Drawings C100, C-601 & EL100.
C.	During construction, the Owner requested enhanced security features to supplement the card access readers specified to control vehicular access. The added features were requested to provide direct communication between the building occupants & visitors to the site; as well as video surveillance of vehicles both entering & leaving the site for security purposes. As such, the District's Security & Sound Vendor (Day Automation) provided a dual head camera & related pedestal, (2) Axis video intercoms w/ integrated card readers, fiber optic panel and access control panel for the new drive entrance from NYS Route 812. All work was provided at discount pricing thru Day Automation Systems NYS OGS Contract PT-68783.
D.	Add for all labor, materials & equipment to provide enhanced security access control features to include exterior dual head camera & related pedestal, (2) Axis video intercoms w/ integrated card readers, fiber optic panel and access control panel for the drive entrance at the new Transportation Facility as per Contract Drawing(s) JC-14.

CHANGE ORDER CERTIFICATION

Part Three

1

Change order requirements:

- ✓ The scope of the change order must relate to the project scope previously approved.
- ✓ Dollar amounts applied from allowances toward costs associated with the changes must be provided.
- ✓ If the cost of this change order is not within the approved amount as currently established on the SA-4, please provide a Form FP-FI, Request for Revision of Financial Information, with documentation showing the additional authorization of funds.
- ✓ Each change order shall be signed by the president of the board of education, the architect/engineer, and the contractor.

2

Certification of the Superintendent of Schools (District Superintendent if a BOCES project)

The following statements are true and correct to the best of my knowledge and belief:

- The revised total cost is within the authorized appropriation for this project.
- Where any work of this change order requires a type or kind of work that is not included in the original contract documents, the school district's attorney has been contacted to assure conformance with the Opinion of the State Comptroller No. 60-505.

_____ Date

_____ Kevin Kendall, Superintendent of Schools

3

Certification of the Architect or Engineer

The following statements are true and correct to the best of my knowledge and belief:

- Work required by this change order is in accordance with applicable sections of the approved contract documents.
- Any plan, sketch, or attachment referenced in this change order is included herein.
- Work required by this change order is in accordance with applicable provisions of the NYS Uniform Fire Prevention and Building Code, State Education Department's building standards, and NYS Department of Labor's Code Rule 56.
- Work required by this change order was designed by an architect or engineer who is currently licensed by the State of New York.
- Work required by this change order that involves asbestos-containing building material (ACBM) was designed by an architect or engineer who is currently licensed by the State of New York and who is appropriately certified as an asbestos designer by the NYS Department of Labor at the time he/she designed the asbestos-related project.

5/7/26

_____ Date

BCA Architects & Engineers

_____ Architectural / Engineering Firm Name



_____ Shawn M. Travers, R.A.